

PLANNING FOR CHANGE:  
21<sup>st</sup> Century Gifted Teachers  
Create, Collaborate, Communicate

Lake Terrace Convention Center

September 25-27, 2013 Hattiesburg, MS



**MAGC CONFERENCE 2013**

## Conference 2013 Committees

### **Conference Sessions:**

\*Deborah Holt  
Carol Paola

### **Pre-Conference:**

\*Donna Welborn  
Sherry Willis  
Terry Gressett  
Pam Keith  
Tabbie Easter  
Michael Cox

### **Scholarships/Awards:**

\*Melissa Pierce

### **Hospitality:**

\*Robin Rector  
Brenda Jones  
Lacy Dykes  
Brandy Fairley  
Beth Roberts  
Rhonda Emmons  
Kelley Rinebold  
Mary Rogers

### **Parent Advocacy:**

Svetlana Lucas

### **Idea Buffet:**

\*Joyce Youngblood  
Cindy Steven-Pheal

### **MAGC Shirts/Bags:**

\*Sherry Willis  
Deborah Holt

### **Exhibitors/Vendors:**

\*Melissa Pierce  
Robin Rector

### **Silent Auction/Supportive Funding:**

\*Tamara Drake  
Diane Campbell  
Ginger Anderson  
Haley Buchanan  
Dolores Bibb

### **Advisory Board/**

### **Past President's Meeting:**

\*Dr. Royal Toy  
Joyce Youngblood

### **CEU Facilitators:**

\*Sabrina Dalton  
Letitia Banks  
Mandy Goldman  
Melody Clymer  
Amber Joyner  
Dana Phippen  
Courtney Ashcraft  
Cynthia Willis  
Chelsea Dean  
Robin Rector  
Lynn Bryan  
Pam Keith  
Bonnie Opel  
Carol Paola  
Karen Leitenberger  
Deborah Holt  
Wendy Hertz  
Donna Welborn  
Kelly Cassibry  
Rhonda Denton  
Carly Parker

### **Registration:**

\*Lisa Saucier

### **Family Night:**

Svetlana Lucas  
D.C. Bridges

### **Concepts:**

Robin Rector

### **Publicity:**

\*Terry Gresse  
Pam Keith  
Cindy Steven-Pheal

### **Technology Committee:**

Elvira Dayenport  
Cindy Steven-Pheal  
Sherry Willis  
Svetlana Lucas  
Vidya Veda

### **Decorations:**

\*Lora Beasley  
Deborah Holt

### **Conference Program:**

Melissa Pierce



Artwork by Claudia  
Hicks, USM  
Former Long Beach  
Gifted Student

Dear MAGC members,

What an honor it is been to serve this past year as your President. However, the President just "holds things together". The MAGC Board Members and Committee Members are the ones who have accomplished so much this past year; I cannot take any of the credit. Due to their hard work:

- ◆ We now have a MAGC Facebook page that keeps our membership informed thanks to Elvira Deyamport, manager of the site.
- ◆ Our members were able to register and pay for the conference on our website [magcweb.org](http://magcweb.org) thanks to Debra Martin, Lisa Saucier, and Sherry Willis.
- ◆ For the first time ever at this conference, we will have [Livebinders.com](http://Livebinders.com) where session presenters can upload their presentation handouts for all conference participants to view. Thanks to Cindy Steven-Pheal's hard work.
- ◆ Our Family Night at conference just keeps getting better thanks to Svetlana Lucas.
- ◆ This conference is packed with more speakers, sessions, and information than ever, thanks to Debbie Holt, Conference Chair, Melissa Pierce, Co-Chair and all of their committee members.
- ◆ Per your request, the Conference Agenda and Sessions were posted on our website prior to the conference.
- ◆ Please support the *MAGC Fifth Annual Painted Hearts Silent Auction*, thanks to Tamara Drake and her committee members it is always a success.
- ◆ The Pre-Conference (Wednesday) is for anyone who is interested in providing appropriate services for gifted students. Each year Donna Welborn, Pre-Conference Chair, just "out does herself!"
- ◆ This year our "Gifted Day at the Capital" was one of the best ever due to the leadership of Michael Cox, our Legislative Chair.
- ◆ Thanks to Robin Rector and Sherry Willis, all of our *Concepts* have been so vividly available on our website.



In closing I want to thank our Executive Director, Carol Paola. Without her I do not know what neither I nor the Board would do. Her vast knowledge of MAGC and gifted education, of which she is always willing to share, we are ever thankful. This past school year I retired. They always said, "You will know when it is time" and I did. My heart will always be with MAGC and all of those gifted students that you, yes you, MAGC members, make a difference in every day. God Bless you and all you do.

Sincerely,  
Rhonda Denton  
2012-2013 MAGC President

## A Message from Carol Paola, MAGC Executive Director



With the new school year starting, I hope you are making plans to attend this year's MAGC Conference at Lake Terrace Convention Center in Hattiesburg. When we were there two years ago, many of you expressed a desire to return to that beautiful facility which offered us a peaceful setting for our conference, as well as easy parking and the charm of Hattiesburg's old-town restaurants and shopping.

You are going to be delighted with the keynote and featured speakers and the high-quality sessions that our conference chair, Debbie Holt, has scheduled for you! We have not one, but TWO great keynote speakers this year, Caroline Coil, an internationally acclaimed speaker, author, trainer, consultant, and educator; and Dr. Mark Runco, the E. Paul Torrance Professor of Creativity and Gifted Education at the University of Georgia. In addition, we welcome two outstanding featured speakers! Dr. Joy Lawson Davis, an award winning author and expert on diversity and equity in gifted education, and Dr. Ken Smith, also an award winning author and adjunct professor, who continues to work in the field. Read all about their areas of expertise in this conference edition of Concepts.

As usual, the Pre-Conference Event organized by Donna Welborn will be packed with staff development for psychometrists, counselors, administrators, and teachers of the gifted. Chauncey Spears, MDE Director of Advanced Learning and Gifted Programs, also will be there to address the revised gifted regulations and much more. You will not want to miss this day of training!

If you have not already done so, consider bringing a basket and/or piece of art work from your area for the silent auction which provides support for MAGC's grants and scholarships. You also might like to volunteer to help with the conference in some way. If so, contact Debbie Holt ([deboraholt@aol.com](mailto:deboraholt@aol.com)).

We still have slots open for the "Idea Buffet" which will be held during lunch on Thursday. If you are a little anxious about presenting in regular sessions, this is a great way to "get your feet wet" in a small group setting! I have visited in many of your classrooms! I know you have great things to share! Submit a proposal to Joyce Youngblood at [jly1272@gmail.com](mailto:jly1272@gmail.com) by Wednesday, Friday, August 9, 2013. Often if your district is hesitant to allow you to attend a conference, they are more accepting if you are a presenter. If accepted, you also will receive a \$25.00 discount on registration. See the website for the proposal and submit it today!

As always, do not hesitate to contact me if you have questions or concerns. Remember, I am only an e-mail away! I hope to see you at the conference!

Your co-worker in the state,

A handwritten signature in cursive script that reads "Carol Paola". The ink is dark and the signature is fluid.



Dear Conference Participants,

Welcome back to the Hub City for the Mississippi Association for Gifted Children's 2013 Conference at the Lake Terrace Convention Center in Hattiesburg. MAGC Conference 2013 is jammed full of great things to give you that exhilarating boost of motivation and many ideas to help with Common Core, STEM, 21<sup>st</sup> Century Skills, and Creativity/Innovation. Conference attendees will have unique opportunities with presentations from Carolyn Coil, Ed.D (Author, Consultant, Pieces of Learning), Dr. Mark Runco (Torrance Center, UGA), Dr. Ken Smith (Author of Challenging Gifted Learners series, Adjunct Professor, Enrichment Coordinator Northfield School District, IL), Mr. Chauncey Spears (MDE Director of Advanced and Gifted Learning), Dr. Joy Lawson Davis (Author, Educator, Consultant: Gifted and Diversity Education, NAGC Board of Directors), and many, many talented educators and researchers from various areas of Mississippi. Educators will come away with a better understanding of Common Core and the gifted child, 21<sup>st</sup> Century learning, the ever-important role of creativity in educating the gifted child, STEM, and technology connections.



There will be three Featured Speaker opportunities, lasting for 45-50 minutes each, 8 breakout sessions (each lasting for 50 minutes), and a Family Night event with another wonderful speaker for parents and educators, Dr. Joy Lawson Davis. Many of the breakout sessions follow the theme of creativity, collaboration, and communication. In addition, teachers will be provided with a working lunch on Thursday, September 26, 2013, with an "Idea Buffet," where teachers will have the chance to visit various learning stations with teachers sharing ideas. The "Idea Buffet" will last for an hour during the boxed-lunch time.

This year, we are making connections to technology and social media a priority to better meet the needs of all conference attendees. For all conference attendees, you will not need an access code at the conference to access Wi-Fi, so you may get on-line with no problem. Also, you will be given a passcode so that you may access all presentations after the conference through Live Binders. So, for those sessions you were not able to get into, no worries, you will be able to get handouts and presentations later through that access code. We will also have our newly formed MAGC Technology Committee on hand to help with any technology needs that may surface. If you haven't joined our Facebook page yet, please find us and ask to join. You will be able to find a great deal of updates by being our "Friend" on Facebook. Of course, we have our MAGC website where you may find a tremendous amount of information on [www.magcweb.org](http://www.magcweb.org).

Another thing being offered this year is that we will have MAGC shirts and bags for sale. These keepsakes will announce to the world your dedication to gifted education in Mississippi, while contributing to making gifted education the best it can be in our state. All proceeds will go towards scholarship money and funding future speakers at conferences.

I have several people that I want to thank for helping to make this conference fabulous! First of all, I want to thank my Conference Co-Chair and MAGC Vice-President, Melissa Pierce, for her hard work with vendors and scholarships/awards and for being a great team player. I especially want to thank Carol Paola, MAGC Executive Director, for being the wonderful friend and mentor to me since the beginning of my teaching career in 1982. I want to thank MAGC President, Rhonda Denton, for her guidance, support, and wise words of advice along the way. Last, but not least, I want to thank all committee chairs for helping to make this conference happen. A conference of this magnitude does not happen with the work of one person, it happens because we have a dynamic group of people on our MAGC Board and MAGC Conference committees! I appreciate every one of you for your dedication and hard work.

I hope you all enjoy MAGC Conference 2013 in Hattiesburg as we are "Planning for Change: 21<sup>st</sup> Century Gifted Teachers Create, Collaborate, Communicate."

Deborah Holt, MAGC President-Elect and Conference Chair  
Melissa Pierce, MAGC Vice-President and Conference Co-Chair



**NOTES**



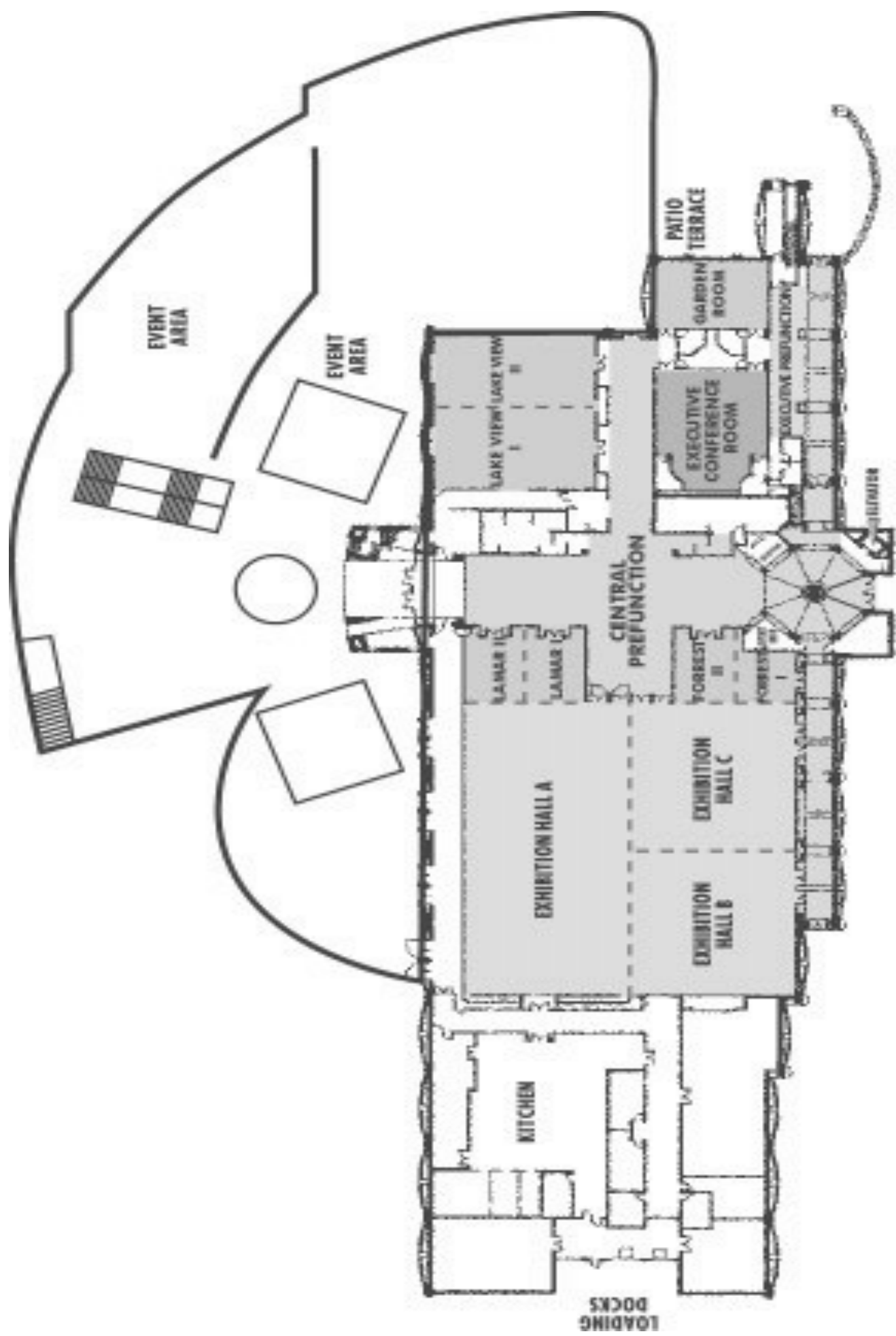



## MAGC Conference 2013 Speakers

### Keynote Speakers



Mark Runco earned his PhD in Cognitive Psychology from the Claremont Graduate School. His research has focused on creativity since that time. Dr. Runco is the Founding Editor of the *Creativity Research Journal* and co-edited the *Encyclopedia of Creativity* in 1999 and 2011. He is currently the E. Paul Torrance Professor of Creativity and Gifted Education at the University of Georgia. In 2010 he published the rCAB, a comprehensive battery of tests for the assessment of creativity. Dr. Runco is a Past President of Division 10 (Psychology, Art, Creativity, and Aesthetics) of the American Psychological Association. His textbook, *Creativity: Theories, themes, and issues* (Academic Press) has been translated into six languages. The new edition of it is due out in 2013, along with his new book, *The New Science of Creativity*.

Carolyn Coil, Ed. D, is an internationally known speaker, author, trainer, consultant and educator. In her workshops, professional development courses, seminars and keynotes, she is an enthusiastic, motivating and energetic presenter. Carolyn works with teachers, parents and students offering practical strategies for raising student achievement, differentiating curriculum, implementing a variety of assessment strategies, and dealing with the problems and challenges associated with preparing ourselves and our children for living and working in the 21st Century.

Carolyn has worked in the field of education and training for over 30 years. She currently teaches courses in gifted and talented education and does workshops for schools and school districts on a wide variety of topics. She has been an Adjunct Professor at several different universities and has worked in the United States, Australia, New Zealand, Hong Kong, Bermuda, the Marshall Islands, Spain, Germany, Ecuador, Croatia, South Korea, China, and Canada.





## Featured Speaker

Kenneth J. Smith, Ph.D., is the author of the popular book series, *Challenging Units for Gifted Learners: Teaching the Way Gifted Student Think*. The National Association for Gifted Children awarded Ken the 2012 Curriculum Studies award for the series' chapter entitled "A Freudian Analysis of Literature." His most recent publications include "The Silent A: Why Art Has Always Been a Part of STEM Expertise" in *Teaching for High Potential* and "From Pop-Up Books to Shakespeare: Writing as Problem Solving across the Grade Levels" in *Gifted Child Today*. Ken has his Ph.D in cognitive psychology from Columbia University. His dissertation was on the effects of linguistic and content knowledge on writing expertise. The content area he studied was football. Over the last 25 years he has been an adjunct professor and has held various positions in the Northfield School District, just north of Chicago. He is currently the enrichment coordinator in the district and is proud of the fact the he is still works with children on a daily basis.



## Featured and Parent Night Speaker



Dr. Joy Lawson Davis is a career educator with over three decades in the field of gifted education. During this time period, Dr. Davis has served as a local gifted education administrator, State Dept of Education Gifted Specialist for the State of Virginia, Executive Director of a Governor's School for gifted learners, researcher, scholar and published author. Most recently Dr. Davis was an Assistant Professor of Education and Director, Center for Gifted Education at the University of Louisiana, Lafayette. Davis' award-winning book: ***Bright, Talented & Black: A guide for families of African American Gifted Learners*** has been well-received nationally. Dr. Davis holds two graduate degrees in Gifted Education from the College of William & Mary in Virginia. An active member of the National Association for Gifted Children, Davis is currently serving a three year term as an at-large member of NAGC's Board of Directors. Prior to her term as a board member, Dr. Davis served for two terms as Chair of NAGC's Diversity & Equity Committee. Dr. Davis sits on the Advisory Board of *Gifted Child Today*, and writes a special populations column for *Teaching for High Potential*. As a sought-out expert on diversity in gifted education, Dr. Davis frequently consults with local school districts, state and national organizations as a keynote speaker and conference presenter helping to advocate for and address the needs of culturally and linguistically diverse gifted learners and their families nationally and internationally.

# Announcing...MAGC T-Shirts and Bags for Sale!

## MAGC Booth #33

Short Sleeved Shirt \$12.00

Long Sleeved Shirt

\$15.00

MAGC Bag

\$7.00

Colors: neon pink, neon orange, neon yellow

Sizes: Adult small, medium, large, or extra large

Front of the shirt and on bags:



Back of the shirt:



### Vendor Map

#### Lake Terrace - Exhibit Hall BC

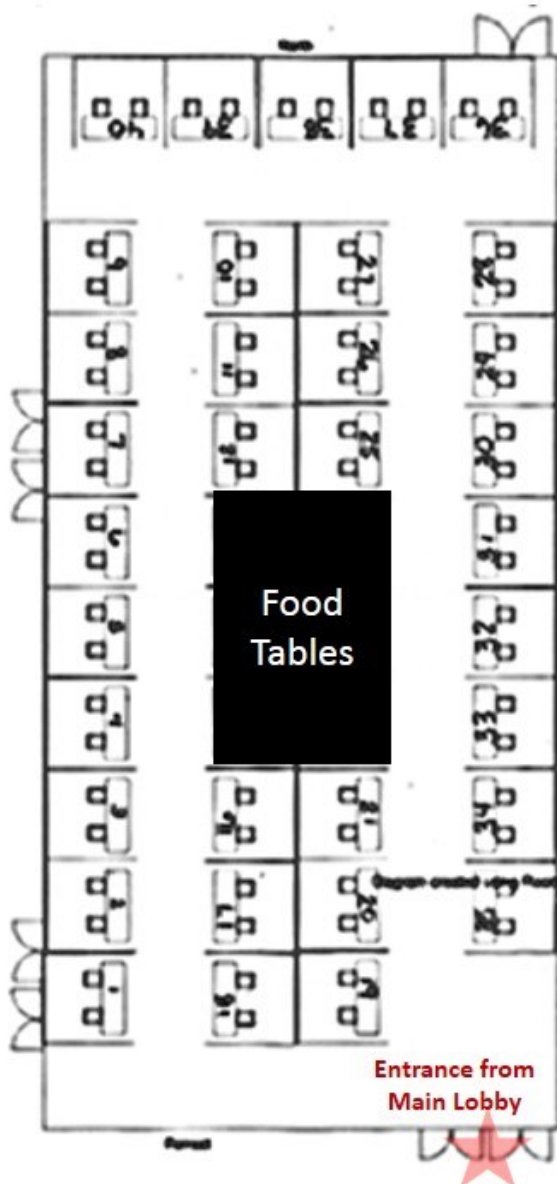

Usborne Books	1	MS Council on Economic Ed	21
Usborne Books	2	Food/Beverage	22
Trek Travel	3	Food/Beverage	23
Destination Imagination	4	Food/Beverage	24
MS School of Math /Science	5	Discovery Toys	25
Institute of Southern Jewish Life	6	Discovery Toys	26
Rodan and Fields	7	MS Professional Educators	27
Dr. Joy Davis	8	MS School of the Arts	28
McDowell Environmental	9	Pieces of Learning	29
Duke University	10	Pieces of Learning	30
McWane Science Center	11	RJB Games – Albert's Insomnia	31
USM Gifted Studies	12	MAGC: Bright Ideas, T-shirts/Bags	32
Food/Beverage	13	MAGC: Bright Ideas, T-Shirts/Bags	33
Food/Beverage	14	Engine-Uity, Ltd.	34
Food/Beverage	15	Engine-Uity, Ltd.	35
MS Dept of Archives	16	Felicity/Uncle Hokum	36
MS Museum of Natural Science	17	LA Ren Fest	37
Teacher's Pet	18	Project Learning Tree	38
Teacher's Pet	19	Championship Chess	39
MS Geographic Alliance	20	Beauticontrol	40



# Painted Hearts

## MAGC 5<sup>th</sup> Annual Painted Hearts Silent Auction

Please join us for the *5<sup>th</sup> Annual Painted Hearts Silent Art Auction* during the 2013 MAGC Conference which will feature original works by many of Mississippi's finest artists, exciting artistic contributions of students, gift baskets, and other specialty items. Conference attendees are invited to place silent bids on these high-quality pieces, while contributing to worthwhile efforts such as suicide prevention, student scholarships, and teacher grants in our state.

**SILENT AUCTION BIDDING CLOSES THURSDAY, SEPTEMBER 26, 2013, 7:30 P.M. AND ALL ITEMS MUST BE PICKED UP BY 10:30 A.M. ON FRIDAY, SEPTEMBER 27, 2013.**

## MAGC CONFERENCE 2013

HATTIESBURG LAKE TERRACE CONVENTION CENTER |





### 2012 MAGC Past Presidents List

#### **1974-1976**

Frances Karnes  
Hattiesburg

#### **1977**

Dr. Doug Evertt  
Enterprise

#### **1978**

Di Ann Lewis  
Jackson

#### **1979**

Dr. Joe Ray Underwood  
Starkville

#### **1980**

Dr. Lela A. Alcorn  
Hattiesburg

#### **1981**

Jean C. Prather  
Clinton

#### **1982**

Dr. Joanne Welch  
Ridgeland

#### **1983**

Pat Beane  
Tupelo

#### **1984**

Dr. Margaret Carmean  
Clinton

#### **1985**

Beverly Alexander  
Mobile, AL

#### **1986**

Melissa Grantham  
Madison

#### **1987**

Dr. Suzanne Bean  
Columbus

#### **1988**

Dr. Marilyn Foxworth  
Columbia

#### **1989**

Linda Kergosien  
Brookhaven

#### **1990**

Marie Charles Cayson  
Aberdeen

#### **1991**

Dr. Mariella Simons  
Brandon

#### **1992**

Sherrye C. Thompson  
Brandon

#### **1993**

Linda Mucha  
Biloxi

#### **1994**

Dr. Betty Montgomery  
Tupelo

#### **1995**

Dr. Gail Hammond  
Brandon

#### **1996**

Carol Paola  
Gulfport

#### **1997**

Dr. Michael Carr  
Cleveland

#### **1998**

Holly Mitchell  
Jackson

#### **1999**

Shelah Reeves  
Jackson

#### **2000**

Jane Pickett  
Pascagoula

#### **2001**

Phyllis Mabowitz  
Mobile

#### **2002**

Jane Everly  
Jackson

#### **2003**

Lia Landrum  
Ellisville

#### **2004**

Mary Webb  
New Albany

#### **2005 – 2006**

Dr. Kate Brown  
Columbus

#### **2007**

Margaret Snider  
Ridgeland

#### **2008**

Teresa Mosley  
Clinton

#### **2009**

Joyce Youngblood  
Gulfport

#### **2010**

Sherry Willis  
Tupelo

#### **2011**

Dr. Sandra Manning  
Laurel

#### **2012**

Glen Nobles  
Hattiesburg





## *MAGC Awards and Scholarships*

<i>MAGC Grant for Teacher to Pursue Gifted Certification</i>	Brandy Fairley, Petal
<i>Dr. Gail Hammond Teacher Scholarship</i>	Traci Gregg, Hernando
<i>Conrad Castle Teacher Grant</i>	TBA
<i>Frances A. Karnes Award for Excellence in Gifted Education</i>	TBA
<i>MAGC Outgoing President</i>	Rhonda Denton, Meridian
<i>Sherry Thompson Parent Advocacy Award</i>	Cliff Long, Long Beach
<i>MAGC Outstanding Superintendent/Administrator Advocacy Recognition</i>	Dr. Marlynn Martin, Principal Power Academic & Performing Arts Complex  Christine Spinks, Assistant Superintendent Long Beach
<i>MAGC Outstanding Advocate Recognition</i>	Randall Hicks, Long Beach Margaret Snider, Jackson Pam Wooten, NorthTippah

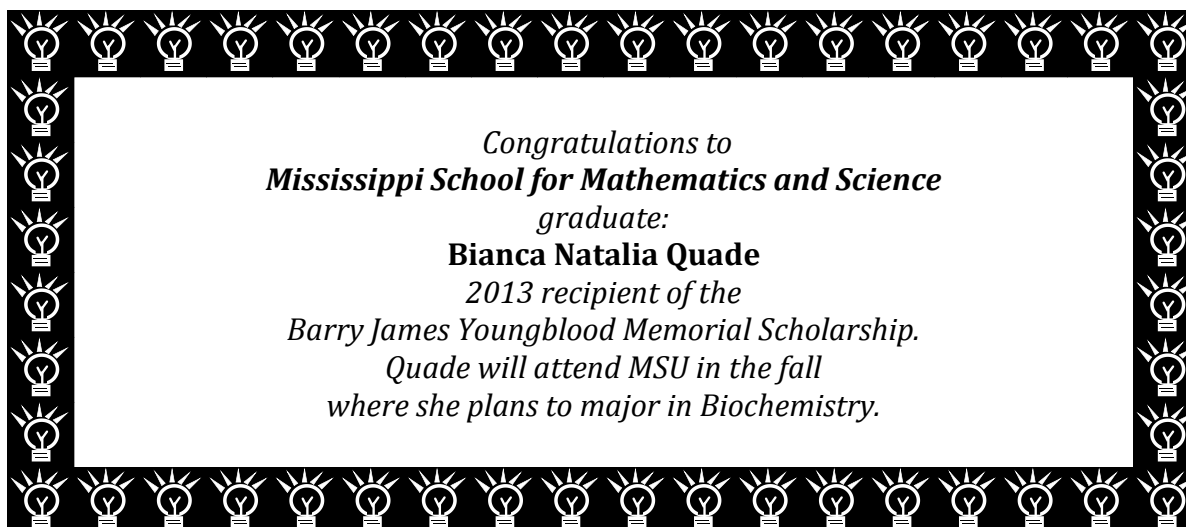

2013 FAMILY NIGHT ‡ THUR., SEPTEMBER 26

5:30pm -- 6:30pm

Lakeview Rooms, Lake Terrace Convention Center



**"The Critical Role of Families in Nurturing & Advocating for ALL High Ability & Gifted Learners"**

**Dr. Joy Lawson Davis**

This session will review research and theory related to the critical nature of family engagement in the lives of high ability/gifted learners and their role as co-partners with educators challenged with working with this exceptional group of students. Particular focus will be on the unique affective and support needs of learners from culturally & linguistically diverse backgrounds. A new tiered family engagement model will be shared which includes the training of a cadre of parent leaders and delivery of services to parents based on their level of experience with gifted education. (Recently published in: Davis, J.L. (2012). The Importance of Family Engagement. In M.R. Coleman & S.K. Johnsen, (Eds.), *Implementing RtI with Gifted Students: Service Models, Trends, and Issues*)

~~~~~



Dr. Joy Lawson Davis, a Virginia native, is a practitioner, educator, consultant, scholar and published author. For over three decades in the field of gifted education, she has focused her advocacy work on increasing attention to the needs of diverse gifted students and their families.

Davis' award-winning book: *'Bright, Talented & Black: A guide for families of African American Gifted Learners'* has been well received nationwide and is the first of its kind to address the needs of African American families and educators focused specifically on the unique needs of diverse gifted learners.

Dr. Davis holds two graduate degrees in Gifted Education from the College of William & Mary in Virginia. An active member of the National Association for Gifted Children and currently serving her second of a three year term as an at-large member of NAGC's Board of Directors, Dr. Davis sits on the Advisory Board of *Gifted Child Today*, a practitioner-oriented peer reviewed journal with the largest subscription base of any gifted education journal in the nation.

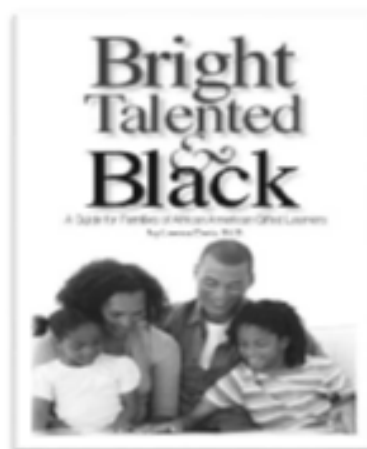

≡ **Interactive Learning Stations for Students during Family Night Program** ≡



# PINE BELT

to the

*Dr. Joy Lawson Davis*

*Advocate for Gifted Children*



School of Education



Hattiesburg Public  
School District



www.ForrestCounty.NAACP.org

## NAACP

Clarence & Carrie Magee  
Sidney Royal



Center for  
Creative Scholars  
WCU



Lamar County  
School District



Parents of Gifted Children Association

## msucares.com<sup>®</sup>

Mississippi Agricultural and Forestry Experiment Station • Mississippi State University Extension Service

# Pine Belt Gifted Teachers' Association



Pine Belt Gifted Teachers' Association was founded in 2005 by a small group of teachers from the Hattiesburg and Laurel areas. The organization was created to bring the Pine Belt Area gifted teachers together to collaborate, share new ideas, and pursue avenues to enhance gifted education in the area. If you are interested in joining PBGTA, please email Lacy Dykes at [lacy.dykes@petalschools.com](mailto:lacy.dykes@petalschools.com). You may also find us on *Facebook*.



## ANNUAL MAGC PRE-CONFERENCE WORKSHOP AGENDA

WEDNESDAY, SEPTEMBER 25, 2013

### Time

### Activity

Emphasis group: P=Psychometrist C=Counselors T=Teachers of the Gifted

- 7:00 -8:00 Registration - Continental Breakfast
- 8:00- 8:30 Opening remarks/Overview of the Agenda.....Donna Reynolds Welborn (DRW)
- 8:30- 9:30 Session #1 (C/T) The Five Unexpected Traits of Gifted Children....Teresa Mosley
- 9:30 -9:45 Session #2 (P) Benefits of Having a Local Psychometry Support Group...Judy Ratcliff
- 9:45-10:00 Break – Continental Breakfast
- 10:00-10:45 Session #3 (P/C/T) What Do These Scores Mean? How to interpret test results... Delbra Thrash
- 10:45-11:30 Session #4 (C/T) Suggestions of actual tactics for dealing with the Social/Emotional needs of the students who are in the gifted classroom ... Yolanda Cobb & Peggy Carlisle
- \*Sessions will continue through the working lunch period. Box lunches will be provided.
- 11:30- 12:00 Session #5 MDE Gifted Regulations Changes..... Chauncey Spears, MDE Director of Gifted Program
- 12:00-12:30 Session #6 (P/T) Review of the NEW MDE Referral to Placement Procedures...DRW  
(Certificate of Completion will be provided to meet Standard VII: 4.3.3)
- 12:30 – 2:15 Session #7 (P/T) Assessment Panel answering questions including Psychometric Best Practices.  
Moderator: DRW  
Panel: Judy Ratcliff, Delbra Thrash, Teresa Mosley, Chauncey Spears, Royal Toy, Carol Paola
- 2:15-2:30 Break – Snacks (\*Last chance to purchase raffle tickets!)
- 2:30-2:45 Session #8 (P/C/T) How to Pursue Legislative Support...Michael Cox
- 2:45-3:30 Closing Remarks.....Donna Reynolds Welborn
- Debriefing
  - Evaluations
  - CEU paperwork
  - Drawing for the Kindle Fire HD...the winner must be present and will be announced at the conclusion of the day-long PD session.

0.6 CEU credits will be awarded for completion of all scheduled events. Each individual seeking CEU credits must sign in, attend all sessions throughout the day, complete an evaluation at the end of the day, provide a completed application, and provide a personal check made out to Mississippi College in the amount of \$10.00.

*\*There will be a Kindle Fire HD raffled off today.*

*Tickets will be priced at \$1 each, 10 for \$5, or 20 for \$10.*

*The drawing will be held at the end of this day and you MUST be present to win!!!!*

## **MAGC Conference ~ Schedule of Events**

### **Thursday, September 26, 2013**

#### **General Opening Session (8:30-9:45) in Exhibit Hall A**

- **Entertainment:** Breanna Traweek,  
Petal's 2014 Distinguished Young Woman  
Introduction: Melissa Pierce, MAGC Vice-President
- **Pledge and National Anthem**
- **Welcomes:** Rhonda Denton, President, MAGC
- **Dr. Frances Karnes, MAGC Founding Member**  
"History of MAGC"
- **Introduction of Featured Speaker:** Carol Paola, MAGC Executive Director
- **Keynote Speaker:** Dr. Mark Runco
- **Announcement:** Debbie Holt, President-Elect, Conference Chair

#### **Keynote: Mark Runco**

**"Planning for Change:  
21st Century Gifted Teachers Create, Collaborate, Communicate."**

#### **Breakout Sessions #1: 10:00-10:50**

| <b>Exhibit Hall A<br/>(300)</b>                                                                                     | <b>Lakeview 1<br/>(120)</b>                                                                                                      | <b>Lakeview 2<br/>(120)</b>                                                                                       | <b>Garden Room<br/>(75)</b>                                                                   |
|---------------------------------------------------------------------------------------------------------------------|----------------------------------------------------------------------------------------------------------------------------------|-------------------------------------------------------------------------------------------------------------------|-----------------------------------------------------------------------------------------------|
| Mark Runco, PhD,<br>(University of Georgia)<br>"Creativity: Why is this the<br>Real Crisis in American<br>Schools?" | Will Deyamport, III, Ed.D<br>"Google Hangouts in the<br>Classroom"                                                               | Maggie Johnston (McDowell<br>Environmental Center<br>Director<br>"Building a Team from Your<br>Smart Individuals" | Carol Paola<br>"Building A Defensible<br>Program: Training for New<br>Teachers of the Gifted" |
| <b>Lamar 1 (50)</b>                                                                                                 | <b>Lamar 2 (50)</b>                                                                                                              | <b>Forrest 1 (40)</b>                                                                                             | <b>Forrest 2 (40)</b>                                                                         |
| Rick Buchner<br>"Improve Standardized<br>Math Scores in Elementary<br>Schools"                                      | Heather Houston, Ph.D<br>"How to Help Your School<br>Understand Gifted Students'<br>Motivational Response to<br>Differentiation" | Bonny Skutch "Using<br>Cinematherapy to Address<br>the Social and Emotional<br>Needs of Gifted Students"          | Kelly Cassibry<br>A Place in Time: "Town in a<br>Time Capsule"                                |

#### **Breakout Sessions #2: 10:55-11:45**

| <b>Exhibit Hall A<br/>(300)</b>                                                       | <b>Lakeview 1<br/>(120)</b>                                                                                                     | <b>Lakeview 2<br/>(120)</b>                       | <b>Garden Room<br/>(75)</b>                                                                                                               |
|---------------------------------------------------------------------------------------|---------------------------------------------------------------------------------------------------------------------------------|---------------------------------------------------|-------------------------------------------------------------------------------------------------------------------------------------------|
| Carolyn Coil<br>"Differentiation, RTI, and<br>Achievement: How They<br>Work Together" | Ken Smith, PhD<br>"The Lessons of Leonardo da<br>Vinci: Visualization,<br>Perseverance, & Innovation<br>in the STEM Curriculum" | Svetlana Lucas<br>"Are You Ready for M-<br>STAR?" | Sara Weeks<br>(Power APAC)<br>"Out of Your Mind"                                                                                          |
| <b>Lamar 1 (50)</b>                                                                   | <b>Lamar 2 (50)</b>                                                                                                             | <b>Forrest 1 (40)</b>                             | <b>Forrest 2 (40)</b>                                                                                                                     |
| Claire E. Gwaltney<br>"Ready, Set, Click! Online<br>History Made Easy"                | Judy Duneheew<br>"Brainy Games"                                                                                                 | Wendy Hertz<br>"Marvelous Me"                     | Elvira Deyamport, Ed.S<br>"The Greatest Stories Never<br>Told: Showcasing Our Gifted<br>Classrooms Through Social<br>Media and Web Tools" |



| <b>Breakout Sessions #3: 1:10-2:00</b>                    |                                                                                                    |                                                                                                   |                                                                                                                          |
|-----------------------------------------------------------|----------------------------------------------------------------------------------------------------|---------------------------------------------------------------------------------------------------|--------------------------------------------------------------------------------------------------------------------------|
| <b>Exhibit Hall A (300)</b>                               | <b>Lakeview 1 (120)</b>                                                                            | <b>Lakeview 2 (120)</b>                                                                           | <b>Garden Room (75)</b>                                                                                                  |
| Chauncey Spears<br>"Review of Revised Gifted Regulations" | Ken Smith, PhD<br>"From Pop-Up Books to Shakespeare: Writing as Problem Solving across the Grades" | Michael Cox, MAGC<br>Legislative Chair "Let's Go to Jackson: Advocacy for the Gifted"             | Charlene Stephens<br>"Implementing Common Core Using Geo-Literacy"                                                       |
| <b>Lamar 1 (50)</b>                                       | <b>Lamar 2 (50)</b>                                                                                | <b>Forrest 1 (40)</b>                                                                             | <b>Forrest 2 (40)</b>                                                                                                    |
| Lauren McAlpin<br>"I Teach Gifted....Now What?"           | Marilyn Tullos<br>"Fantastically Fun Physics"                                                      | Rachel Myers (Institute of Southern Jewish Life)<br>"The Mississippi Jewish Immigrant Experience" | Rick Smith<br>"Blogging Your Way to More Timely PLC's: Finding and Using the best Educational Blogs for YOUR classrooms" |

| <b>Breakout Sessions #4: 2:05-2:55</b>                            |                                                                     |                                                                                                                   |                                                              |
|-------------------------------------------------------------------|---------------------------------------------------------------------|-------------------------------------------------------------------------------------------------------------------|--------------------------------------------------------------|
| <b>Exhibit Hall A (300)</b>                                       | <b>Lakeview 1 (120)</b>                                             | <b>Lakeview 2 (120)</b>                                                                                           | <b>Garden Room (75)</b>                                      |
| Carolyn Coil<br>"Teaching Tools for the 21 <sup>st</sup> Century" | Mariah L. Smith, PhD<br>"4-H Robotics: Beyond Plow, Cows, and Sows" | Maggie Johnston (McDowell Environmental Center Director)<br>"Building a Team from Your Smart Individuals"         | Deborah Holt<br>"Project Innovate: The Power of Innovation"  |
| <b>Lamar 1 (50)</b>                                               | <b>Lamar 2 (50)</b>                                                 | <b>Forrest 1 (40)</b>                                                                                             | <b>Forrest 2 (40)</b>                                        |
| Dennis Jones,<br>"Championship Chess and Cognitive Outcomes"      | Ginger Langford<br>"Fly Me to the Moon"                             | Heath Stevens, Ph.D., LSC, NCC, ACS<br>"Making Mississippi's Gifted Excel: The Flagship Programs of MGS and MSMS" | Gail Spinnato<br>"Environmental Awareness is a TOP Priority" |

| <b>Breakout Sessions #5: 3:10-4:00</b>                         |                                                                                      |                                                                                                                                           |                                                                                   |
|----------------------------------------------------------------|--------------------------------------------------------------------------------------|-------------------------------------------------------------------------------------------------------------------------------------------|-----------------------------------------------------------------------------------|
| <b>Exhibit Hall A (300)</b>                                    | <b>Lakeview 1 (120)</b>                                                              | <b>Lakeview 2 (120)</b>                                                                                                                   | <b>Garden Room (75)</b>                                                           |
| Carolyn Coil<br>"Solving the Assessment Puzzle Piece by Piece" | Will Deyamport, III, Ed.D<br>"Flipping the Classroom"                                | Christina McDaniel<br>"Engineering in the classroom"                                                                                      | Donna Welborn<br>"Gifted Referral to Placement....Let's Figure This Out Together" |
| <b>Lamar 1 (50)</b>                                            | <b>Lamar 2 (50)</b>                                                                  | <b>Forrest 1 (40)</b>                                                                                                                     | <b>Forrest 2 (40)</b>                                                             |
| Judy Dunehew<br>"Brainy Games"                                 | Kay Williams<br>Ed.S<br>"Integrating Geography Activities Into the Gifted Classroom" | Richard Courtright, Ph.D.<br>"Socratic Inquiry: Acquiring 21 <sup>st</sup> Century Skills from a 4 <sup>th</sup> Century B.C.E. Strategy" | Mary Roberts<br>"Creativity, Collaboration, and Communication"                    |

| <b>Breakout Sessions #6: 4:05-4:55</b>                        |                                                                                      |                                                                                                                  |                                                                 |
|---------------------------------------------------------------|--------------------------------------------------------------------------------------|------------------------------------------------------------------------------------------------------------------|-----------------------------------------------------------------|
| <b>Exhibit Hall A (300)</b>                                   | <b>Lakeview 1 (120)</b>                                                              | <b>Lakeview 2 (120)</b>                                                                                          | <b>Garden Room (75)</b>                                         |
| Dr. Joy Davis<br>*Rigor and Relevancy                         | Jen Cornett<br>"Gifted to the Core"                                                  | Christina McDaniel<br>"Mission Intermodal:<br>Bringing Intermodal Global<br>Transportation to Your<br>Classroom" | Carol Paola,<br>"Training for New Gifted<br>Contact Persons"    |
| <b>Lamar 1 (50)</b>                                           | <b>Lamar 2 (50)</b>                                                                  | <b>Forrest 1 (40)</b>                                                                                            | <b>Forrest 2 (40)</b>                                           |
| Kacee Hobson<br>"Creative Projects for the<br>Gifted Learner" | Dr. Royal Toy, "Targeting<br>Conflict Management: Time,<br>Relationships, and Tasks" | Mary Cole from Engine-Uity,<br>Ltd.<br>"Everything Old is New<br>Again"                                          | Donna Mabus<br>"Inspiring Future Engineers<br>Through Robotics" |

**Past-President's and Advisory Board Meeting: 5:30-6:00**

Executive Conference Room

**Family Night 5:30-6:30**

Dr. Joy Lawson Davis on "The Critical Role of Families in Nurturing and Advocating for ALL High Ability and Gifted Learners" in Lakeview Rooms 1 and 2

# Planning For Change





**MAGC Conference ~ Schedule of Events****Friday, September 27, 2013****8:00-10:00****(Exhibit Hall A)**

- Entertainment: Breanna Traweek,  
Petal's 2014 Distinguished Young Woman
- MAGC Business Session-Rhonda Denton, President, MAGC
- MAGC Awards Presentation-Melissa Pierce, Vice-President MAGC
- Introduction of Featured Speaker, Carol Paola, MAGC Executive Director
- Featured Speaker: Carolyn Coil "Common Core, 21<sup>st</sup> Century Learning and the Gifted Child"
- Announcement of Frances A. Karnes Award for Excellence-Melissa Pierce, Vice-President MAGC. Presented by Carol Paola, Executive Director
- Announcements: Debbie Holt/President-Elect, Conference Chair

**Keynote: Carolyn Coil****"Common Core, 21<sup>st</sup> Century Learning and the Gifted Child"**

| <b>Breakout Sessions #7 10:10-11:00</b>                                                     |                                                                 |                                                                                                                                |                                           |
|---------------------------------------------------------------------------------------------|-----------------------------------------------------------------|--------------------------------------------------------------------------------------------------------------------------------|-------------------------------------------|
| <b>Exhibit Hall A (300)</b>                                                                 | <b>Lakeview 1 (120)</b>                                         | <b>Lakeview 2 (120)</b>                                                                                                        | <b>Garden Room (75)</b>                   |
| Carolyn Coil<br>"Differentiated Activities and Assessments Using the Common Core Standards" | Dr. Ken Smith<br>"A Freudian Analysis of Literature"            | James Wilcox<br>"No Room for a Sneeze and More From EconEdLink"                                                                | Brooke Bowden<br>"Creativity 101"         |
| <b>Lamar 1 (50)</b>                                                                         | <b>Lamar 2 (50)</b>                                             | <b>Forrest 1 (40)</b>                                                                                                          | <b>Forrest 2 (40)</b>                     |
| Jen Cornett<br>"On A Roller Coaster: Newton's Laws of Fun"                                  | Michelle Turner<br>"Journaling Success in The Gifted Classroom" | Richard Courtright, Ph.D.<br>"Pulling it All Together: A Synthesis Model for Differentiated Curriculum for the Gifted Learner" | Sherra McElroy<br>"Medieval Marshmallows" |

| <b>Breakout Sessions #8: 11:10-12:00</b>                                 |                                                              |                                                                                                             |                                                                          |
|--------------------------------------------------------------------------|--------------------------------------------------------------|-------------------------------------------------------------------------------------------------------------|--------------------------------------------------------------------------|
| <b>Exhibit Hall A (300)</b>                                              | <b>Lakeview 1 (120)</b>                                      | <b>Lakeview 2 (120)</b>                                                                                     | <b>Garden Room (75)</b>                                                  |
| Chauncey Spears<br>"A Common Core Up-Date for Gifted Educators"          | Dr. Ken Smith<br>"Storytelling: The Joy of Writing Out Loud" | Dr. Joy Davis<br>"Ensuring Equity and Excellence in Gifted Education Programs"                              | Carol Paola<br>"Civic Engagement for Gifted Kids: Welcome to Jolly Town" |
| <b>Lamar 1 (50)</b>                                                      | <b>Lamar 2 (50)</b>                                          | <b>Forrest 1 (40)</b>                                                                                       | <b>Forrest 2 (40)</b>                                                    |
| Stacey Everett<br>"Get Creative! Sneak Social Studies into Your Lessons" | Sherry Willis<br>"To Read or Not To Read"                    | Richard Courtright, PhD<br>"TIP-ical Kids: Social and Emotional Aspects of High Ability Children and Youth" | Carly Parker<br>"Order in the Court"                                     |

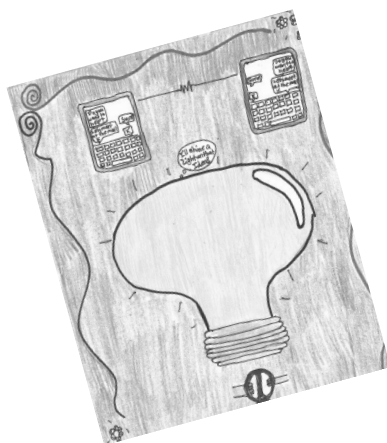

# Idea Buffet

Thursday 12:00-1:00 in Exhibit Hall A

Come sample our smorgasbord of creative ideas shared by our talented MAGC members. Rotations will take place every 15 minutes, and participants may select four sessions to attend.

## *Presenters:*

|                    |                                          |                                                                       |
|--------------------|------------------------------------------|-----------------------------------------------------------------------|
| Ali Papp           | McDowell Environmental Center            | "Loupe T Loupe"                                                       |
| Nicole Deyamport   | Hinds County Gifted Teacher              | "Mysterious Machine"                                                  |
| Janet Paczak       | Rankin County Gifted Teacher             | "Making Creative Chess Sets"                                          |
| Carol Paola        | Long Beach Gifted Teacher                | "The Best Bedroom Ever"                                               |
| Terry Gressett     | Union Gifted Teacher                     | "Super Hero Robots"                                                   |
| Lora Beasley       | Sumrall Gifted Teacher                   | "Research As Easy As 1-2-3"                                           |
| Joyce Youngblood   | MS Geography Alliance Teacher Consultant |                                                                       |
|                    |                                          | "National Parks, National Treasures"                                  |
| Ashley Barefoot    | Lamar County Gifted Teacher              |                                                                       |
|                    |                                          | "Agendas for Sanity and Time Management"                              |
| Wendy Herst        | Long Beach Gifted Teacher                | "Creative Thinking Skills to Add<br>Flavor to the Educational Palate" |
| Karen Leitenberger | Long Beach Gifted Teacher                | "CARE: Care, Appreciation,<br>Respect, Empathy"                       |
| Lisa Saucier       | Rankin County Gifted Teacher             | "Instant Cartooning"                                                  |
| Robin Rector       | Petal Gifted Teacher                     | "NewsCrafted"                                                         |

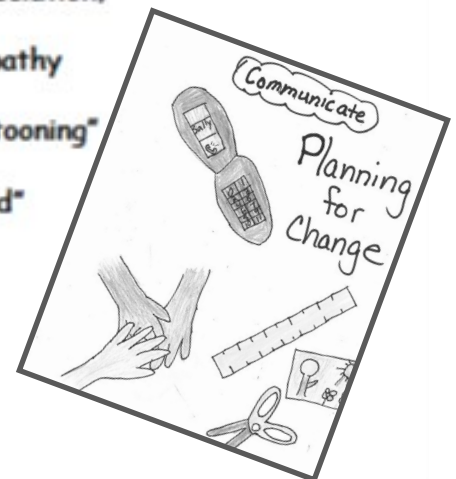
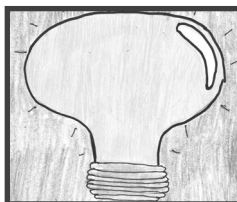



**Session Abstracts**  
**Thursday, September 26, 2013**

**Presentation Category Key**

- 1- Social/Emotional needs of gifted
- 2- Differentiating curriculum & instruction
- 3- Creativity/Innovation
- 4- Evaluating student progress
- 5- Common Core Standards and Gifted
- 6- Special populations
- 7- Developing leadership

**8- Research**

- 9-New Teacher Evaluation Instrument
- 10-Gifted Regulations
- 11-Advocacy
- 12-Special Programs
- 13-Assessment
- 14-MDE Standards Evaluation
- 15-STEM

**Intended Audience Key:**

- A-Elementary teachers
- B- Middle/Secondary teachers
- C- Parents of Gifted Children
- D- Administrators/Counselors/  
Gifted Contacts/Coordinators
- E- Psychometrists/Examiners

| <b>Breakout Sessions #1: 10:00-10:50</b>                                                                                                                                                                                                                                                                                                                                                                                                                                                                                                                                                                                                                                                                                                                       |                                                                                                 |                                                   |
|----------------------------------------------------------------------------------------------------------------------------------------------------------------------------------------------------------------------------------------------------------------------------------------------------------------------------------------------------------------------------------------------------------------------------------------------------------------------------------------------------------------------------------------------------------------------------------------------------------------------------------------------------------------------------------------------------------------------------------------------------------------|-------------------------------------------------------------------------------------------------|---------------------------------------------------|
| <b>"Creativity: Why is this the Real Crisis in American Schools?"</b>                                                                                                                                                                                                                                                                                                                                                                                                                                                                                                                                                                                                                                                                                          | <b>Mark Runco, PhD, (University of Georgia E. Paul Torrance Center Professor of Creativity)</b> | <b>Exhibit Hall A<br/>1, 2, 3, 7; A, B, C, D,</b> |
| There is a real crisis in American schools and it has nothing to do with test scores. There is no room in today's curriculum for creativity and most educators think that creativity only belongs in the art class. This "art bias" to creativity is unfounded. When scholars gave creativity tasks to both engineering majors and music majors, their scores laid down on an identical spectrum. Inside their brains, the same thing was happening- ideas were being generated and evaluated on the fly. Come listen to Dr. Runco, University of Georgia's E. Paul Torrance Professor of Creativity Studies, talk about creativity and share his expertise in which programs develop these higher level thinking skills that are needed in today's workplace. |                                                                                                 |                                                   |
| <b>"Google Hangouts in the Classroom"</b>                                                                                                                                                                                                                                                                                                                                                                                                                                                                                                                                                                                                                                                                                                                      | <b>Will Deyamport, III, Ed.D<br/>Instructional Technologist,<br/>Hattiesburg Public Schools</b> | <b>Lakeview 1<br/>3; A, B, D</b>                  |
| Teachers, who attend this workshop, will learn how to use Google Hangouts as a community outreach tool to conduct virtual parent/teacher conferences, and as a learning tool to host discussions with experts or authors or collaborate with other classes on a variety of projects. The participants will need an active Google+ account and a laptop. If the participants haven't activated their Google+ account, they will be shown how to do so during the workshop.                                                                                                                                                                                                                                                                                      |                                                                                                 |                                                   |
| <b>"Building a Team from Your Smart Individuals"</b>                                                                                                                                                                                                                                                                                                                                                                                                                                                                                                                                                                                                                                                                                                           | <b>Maggie Johnston, Director<br/>McDowell Environmental Center</b>                              | <b>Lakeview 2<br/>1, 2, 3; A, C, D</b>            |
| Do you have students who are great thinkers, but struggle when required to work with peers? You see the leadership potential in your students each day. Help them to see it in themselves. This workshop will guide you through some games and activities you can do to build students' creativity, ability to communicate well and motivation to collaborate with others. Be prepared to get out of your seats and play games!                                                                                                                                                                                                                                                                                                                                |                                                                                                 |                                                   |
| <b>"Building A Defensible Program: Training for New Teachers of the Gifted"</b>                                                                                                                                                                                                                                                                                                                                                                                                                                                                                                                                                                                                                                                                                | <b>Carol Paola<br/>MAGC Executive Director</b>                                                  | <b>Garden Room<br/>1, 2, 3, 4, 5, 7; A, D</b>     |
| Calling all new teachers of the gifted and those of you feeling the need of renewal! Join in this sharing session to help our new teachers get started. Become a "Mentor for a Year" and share practical ideas for building a defensible gifted program. Come prepared to share ideas for procedures, working with classroom teachers, differentiated curriculum, fieldwork, simulations, real-life problem based learning, learning environments, assessments, and more.                                                                                                                                                                                                                                                                                      |                                                                                                 |                                                   |
| <b>"Improve Standardized Math Scores in Elementary Schools"</b>                                                                                                                                                                                                                                                                                                                                                                                                                                                                                                                                                                                                                                                                                                | <b>Rick Buchner<br/>Owner RJB3 Games</b>                                                        | <b>Lamar 1<br/>1, 2, 3, 4, 5; A, B, D</b>         |
| Are you looking for resources to inspire your students' mathematical thinking? In this session you'll learn how to give students access to the flexible thinking whether they're just beginning to add and subtract or exploring bases and exponents. Learn how to help your students meet and exceed their math achievement goals by giving them the opportunity to practice the skills and concepts set aligned with CCSS while having a blast. Be careful, it's addictive.                                                                                                                                                                                                                                                                                  |                                                                                                 |                                                   |
| <b>"How to Help Your School Understand Gifted Students' Motivational Response to Differentiation"</b>                                                                                                                                                                                                                                                                                                                                                                                                                                                                                                                                                                                                                                                          | <b>Heather Houston, Ph.D<br/>Lamar County Schools</b>                                           | <b>Lamar 2<br/>2, 7, 8; A, B, D</b>               |
| Teachers of the Gifted can become change agents in their schools by helping their colleagues in regular classrooms become adept at the use of a variety of teaching strategies. Based in gifted methodology, these strategies have shown significant differences in gifted students' motivation for domain specific courses. Results of recent doctoral research will be used to present and model a variety of strategies. Come prepared to discuss ways to overcome barriers to intra-school collaboration.                                                                                                                                                                                                                                                  |                                                                                                 |                                                   |

|                                                                                                                                                                                                                                                                                                                                                                                                                                                                                                                      |                                                  |                                    |
|----------------------------------------------------------------------------------------------------------------------------------------------------------------------------------------------------------------------------------------------------------------------------------------------------------------------------------------------------------------------------------------------------------------------------------------------------------------------------------------------------------------------|--------------------------------------------------|------------------------------------|
| <b>"Using Cinematherapy to Address the Social and Emotional Needs of Gifted Students"</b>                                                                                                                                                                                                                                                                                                                                                                                                                            | <b>Bonny Skutch<br/>South Hancock Elementary</b> | <b>Forrest 1<br/>1; A, C</b>       |
| Attend to your elementary gifted students' varied social and emotional needs using movies that students love! This session presents participants with guidelines and information for using Cinema-therapy in the classroom even in the midst of high stakes testing! A videography as well as sample lesson plans are given and demonstrated that address S/E needs dealing with leadership, peer relationships, perfectionism, pressure, acceptance, underachievement, humility, overexcitabilities, and diversity. |                                                  |                                    |
| <b>A Place in Time: "Town in a Time Capsule"</b>                                                                                                                                                                                                                                                                                                                                                                                                                                                                     | <b>Kelly Cassibry<br/>Long Beach Schools</b>     | <b>Forrest 2<br/>1, 3, 7; A, B</b> |
| No matter how things CHANGE, they still REMAIN the same! The basic needs of man have REMAINED the same throughout time, but how we fulfill those needs CHANGES over time. This project explores the six basic needs of MAN and the history and innovations developed over time for MAN to survive. Using this information, the students create a product that captures life during a period of time, while learning to appreciate the past, their community, and contributions of others.                            |                                                  |                                    |

|                                                                                                                                                                                                                                                                                                                                                                                                                                                                                                                                                                                                                                                 |                                                                                     |                                                     |
|-------------------------------------------------------------------------------------------------------------------------------------------------------------------------------------------------------------------------------------------------------------------------------------------------------------------------------------------------------------------------------------------------------------------------------------------------------------------------------------------------------------------------------------------------------------------------------------------------------------------------------------------------|-------------------------------------------------------------------------------------|-----------------------------------------------------|
| <b>Breakout Sessions #2: 10:55-11:45</b>                                                                                                                                                                                                                                                                                                                                                                                                                                                                                                                                                                                                        |                                                                                     |                                                     |
| <b>"Differentiation, RTI, and Achievement: How They Work Together"</b>                                                                                                                                                                                                                                                                                                                                                                                                                                                                                                                                                                          | <b>Carolyn Coil, Ed.D<br/>Pieces of Learning</b>                                    | <b>Exhibit Hall A<br/>1, 2, 3, 4, 5, 6; A, B, D</b> |
| Learn how to incorporate practical differentiation and behavioral strategies into an RTI approach that works for gifted students. See how to use pre-assessments to determine individual student strengths and weaknesses. Discover the benefits of formative assessments to assess and monitor the effect of each strategy on individual achievement. Our examples will focus on Curriculum Compacting, Peer Pressure and Organizational Skills. You will leave this session with new ideas strategies, and easy-to-use Progress Monitoring Forms you can use immediately.                                                                     |                                                                                     |                                                     |
| <b>"The Lessons of Leonardo da Vinci: Visualization, Perseverance, and Innovation in the STEM Curriculum"</b>                                                                                                                                                                                                                                                                                                                                                                                                                                                                                                                                   | <b>Ken Smith, PhD<br/>Author and District Enrichment Coordinator Northfield, IL</b> | <b>Lakeview 1<br/>1, 2, 3, 15; A, B, D</b>          |
| In his recent article, <i>The Silent A: Why Art Has Always Been Part of STEM Expertise</i> (Teaching for High Potential, in press), Ken Smith suggests that teachers study the cognitive processes in which da Vinci engaged and then foster these processes in their students. In this workshop based on his article, Ken reviews da Vinci's focus on problem definition, cause and effect, perseverance, and innovation. He discusses how to develop these traits in students through STEM curriculum and visual-spatial thinking. Throughout the workshop, Ken uses the designing of a working miniature golf course as the model STEM unit. |                                                                                     |                                                     |
| <b>"Are You Ready for M-STAR?"</b>                                                                                                                                                                                                                                                                                                                                                                                                                                                                                                                                                                                                              | <b>Svetlana Lucas<br/>Lamar County Schools</b>                                      | <b>Lakeview 2<br/>9; A, B, D</b>                    |
| M-STAR represents a significant change in the formative and summative evaluation process of teachers in that it requires administrators to work alongside teachers to develop a working document which, when used proactively, and in preparation for a formative evaluation, will assist administrators and teachers in having purposeful conversations regarding learning activities in the classroom. This workshop will help to prepare teachers of the gifted for what is to come.                                                                                                                                                         |                                                                                     |                                                     |
| <b>"Out of Your Mind"</b>                                                                                                                                                                                                                                                                                                                                                                                                                                                                                                                                                                                                                       | <b>Sara Weeks<br/>(Power APAC)</b>                                                  | <b>Garden Room<br/>3; A</b>                         |
| Gifted teacher resources are very difficult to come by. This session is designed to give gifted education teachers a variety of resources to pull from to adapt or modify for their own personal usage in whatever form or fashion necessary. Teachers, administrators, or other attendees of this session will also receive a technique used to brainstorm units taught in a gifted classroom. At the end of the session, attendees will be encouraged to share ideas.                                                                                                                                                                         |                                                                                     |                                                     |
| <b>"Ready, Set, Click! Online History Made Easy"</b>                                                                                                                                                                                                                                                                                                                                                                                                                                                                                                                                                                                            | <b>Claire E. Gwaltney<br/>MS Dept. of Archives and History</b>                      | <b>Lamar 1<br/>3; A, B, C</b>                       |
| Mississippi Department of Archives and History's education staff introduces the new MDAH website and its features. Explore all the new free resources for your classroom and fun activities for your students. Check into opportunities for you and your students to participate in MDAH contests, activities and on-site programs across the state.                                                                                                                                                                                                                                                                                            |                                                                                     |                                                     |



|                                                                                                                                                                                                                                                                                                                                                                                                                                                                                                                                                                                            |                                                              |                                     |
|--------------------------------------------------------------------------------------------------------------------------------------------------------------------------------------------------------------------------------------------------------------------------------------------------------------------------------------------------------------------------------------------------------------------------------------------------------------------------------------------------------------------------------------------------------------------------------------------|--------------------------------------------------------------|-------------------------------------|
| <b>Brainy Games</b>                                                                                                                                                                                                                                                                                                                                                                                                                                                                                                                                                                        | <b>Judy Duneheew</b>                                         | <b>Lamar 2<br/>1, 2, 3; A, C, D</b> |
| Are you a quick thinker, have a good eye, or just always seem to get the luck of the draw? These brain-bending games can be played in many different ways and settings on several different challenging levels. Learn how to build vocabulary, deductive reasoning and observational skills with these featured award-winning games such as Qwirkle, Mine Shift, Logic Links, Line Up, Look Look Pentago, and many more will be introduced and taught.                                                                                                                                     |                                                              |                                     |
| <b>"Marvelous Me"</b>                                                                                                                                                                                                                                                                                                                                                                                                                                                                                                                                                                      | <b>Wendy Hertz<br/>Long Beach Schools</b>                    | <b>Forrest 1<br/>1,3;A</b>          |
| Capture the "Marvelous Me" in each of your students! During this unit, the student completes reflective questions to create a narrative script for a digital movie. Using a computer, a digital camera, and their imagination, each child creates a memory that "shows" their individuality. When the project is complete, the student possesses a permanent product as well as an awareness and appreciation of their uniqueness. "I may not be perfect, but I am perfectly me!"                                                                                                          |                                                              |                                     |
| <b>"The Greatest Stories Never Told:<br/>Showcasing Our Gifted Classrooms<br/>Through Social Media and Web<br/>Tools"</b>                                                                                                                                                                                                                                                                                                                                                                                                                                                                  | <b>Elvira Deyampert, Ed.S<br/>Hattiesburg Public Schools</b> | <b>Forrest 2<br/>2, 3; A, B, D</b>  |
| As social media and Web 2.0 tools become more prevalent, educators of the gifted should take notice and advantage of the benefits these tools have to offer. In this session, administrators, teachers, and gifted education coordinators will explore how tools like blogs, Twitter, and Facebook can be used to showcase our gifted classrooms, while serve as advocacy tools for our unique learners. This session will focus on the unique features, resources, and practical recommendations for using web tools in the gifted classroom. Gifted classroom blogs will also be shared. |                                                              |                                     |

|                                                                                                                                                                                                                                                                                                                                                                                                                                                                                                                                                                           |                                                                                          |                                              |
|---------------------------------------------------------------------------------------------------------------------------------------------------------------------------------------------------------------------------------------------------------------------------------------------------------------------------------------------------------------------------------------------------------------------------------------------------------------------------------------------------------------------------------------------------------------------------|------------------------------------------------------------------------------------------|----------------------------------------------|
| <b>Breakout Sessions #3: 1:10-2:00</b>                                                                                                                                                                                                                                                                                                                                                                                                                                                                                                                                    |                                                                                          |                                              |
| <b>"Review of Revised Gifted<br/>Regulations"</b>                                                                                                                                                                                                                                                                                                                                                                                                                                                                                                                         | <b>Chauncey Spears<br/>MDE Director of Advanced<br/>Learning and Gifted Programs</b>     | <b>Exhibit Hall A<br/>10; A, D</b>           |
| Are you a gifted contact person? This session will provide an overview of revised gifted regulations and the standards along with suggestions for dealing with issues related to referral, testing, maintaining contact with parents, increased class size and funding. Questions will be welcome.                                                                                                                                                                                                                                                                        |                                                                                          |                                              |
| <b>"From Pop-Up Books to<br/>Shakespeare: Writing as Problem<br/>Solving across the Grades"</b>                                                                                                                                                                                                                                                                                                                                                                                                                                                                           | <b>Ken Smith, Ph.D<br/>Author and District Enrichment<br/>Coordinator Northfield, IL</b> | <b>Lakeview 1<br/>1, 2, 3; A, C, D</b>       |
| A growing body of research suggests that talented writers engage in a writing process that is qualitatively superior to that used by more typical students. Yet, rather than encourage this more complex writing process, schools often teach talented students simply to become proficient beginners. Ken Smith has published reviews of this research along with curricular models in Gifted Child Today (Spring, 2008; in press). In this workshop, he will present both the model and a variety of projects for instructing talented writers across the grade levels. |                                                                                          |                                              |
| <b>Let's Go to Jackson:<br/>Advocacy for the Gifted</b>                                                                                                                                                                                                                                                                                                                                                                                                                                                                                                                   | <b>Michael Cox</b>                                                                       | <b>Lakeview 2<br/>2, 3, 4, 5, 7; A, B, D</b> |
| In this breakout session, we will discuss the MAGC Day at the Capitol on January 7, 2013. Also, we will cover practical considerations for planning a trip to the Capitol, suggestions for involving parents and community members, and curriculum connections (including research projects, games and puzzles).                                                                                                                                                                                                                                                          |                                                                                          |                                              |
| <b>"Implementing Common Core<br/>Using Geo-Literacy"</b>                                                                                                                                                                                                                                                                                                                                                                                                                                                                                                                  | <b>Charlene Stephens<br/>Mississippi Geographic Alliance</b>                             | <b>Garden Room<br/>5; A</b>                  |
| The workshop will focus on new ways to incorporate Common Core objectives through Geo-Literacy. Today's students must gain a better understanding of the world and how it works; its various cultures and how the world is connected; how to make well-reasoned decisions; and environmental population issues in order to function as global citizens. This workshop will show how you are already using these themes and how they can easily be linked to common core standards.                                                                                        |                                                                                          |                                              |
| <b>"I Teach Gifted...Now What?"</b>                                                                                                                                                                                                                                                                                                                                                                                                                                                                                                                                       | <b>Lauren McAlpin<br/>Jackson Public Schools</b>                                         | <b>Lamar 1<br/>2, 3; A</b>                   |
| New to teaching gifted? Need practical ideas to implement in your classroom to meet the needs of your gifted students? Join us as we examine best practices of veteran teachers of the gifted focusing on classroom design, organizational and learning tools, center design and implementation, and a variety of other strategies that make writing units for your students fun and easier to manage.                                                                                                                                                                    |                                                                                          |                                              |

|                                                                                                                                                                                                                                                                                                                                                                                                                                                                                                 |                                                                |                                                        |
|-------------------------------------------------------------------------------------------------------------------------------------------------------------------------------------------------------------------------------------------------------------------------------------------------------------------------------------------------------------------------------------------------------------------------------------------------------------------------------------------------|----------------------------------------------------------------|--------------------------------------------------------|
| <b>"Fantastically Fun Physics"</b>                                                                                                                                                                                                                                                                                                                                                                                                                                                              | <b>Marilyn Tullos<br/>Rankin County Schools</b>                | <b>Lamar 2<br/>3, 5; A</b>                             |
| By combining simple physics principles, creativity, and marketing, lead students behind the scenes to plan and design their very own theme park complete with a working model of a roller coaster, a park plan, and an advertising campaign. Your students will be so immersed; they won't know they are learning.                                                                                                                                                                              |                                                                |                                                        |
| <b>"The Mississippi Jewish Immigrant Experience"</b>                                                                                                                                                                                                                                                                                                                                                                                                                                            | <b>Rachel Myers<br/>Institute of Southern Jewish Life</b>      | <b>Forrest 1<br/>3, 5, 6, 7; A</b>                     |
| Learn about the Museum of the Southern Jewish Experience Traveling Trunk Program! Your students will enjoy this hands-on educational opportunity containing artifacts, photographs, costumes, maps, and board games that teach students about immigration to the American South. This exploration of Southern Jewish heritage using primary documents and interactive activities will help lead students to an important understanding and appreciation for our region's culture and diversity. |                                                                |                                                        |
| <b>"Blogging Your Way to More Timely PLC's: Finding and Using the best Educational Blogs for YOUR classrooms"</b>                                                                                                                                                                                                                                                                                                                                                                               | <b>Rick Smith<br/>MSMS<br/>Director for School Advancement</b> | <b>Forrest 2<br/>2, 7; A, B, C, D</b>                  |
| Involvement in Personal Learning Communities (PLC's) is essential if educators are to stay current in their fields, and online PLC's offer unique opportunities to be involved with the best minds and latest ideas. This session will introduce participants to fifteen of the top educational blogs, highlighting what they offer subscribers and showing participants how to manage their blogs and effectively incorporate blogging into their own classrooms.                              |                                                                |                                                        |
| <b>"Let's Go to Jackson: Advocacy for the Gifted"</b>                                                                                                                                                                                                                                                                                                                                                                                                                                           | <b>Michael Cox<br/>MAGC Legislative Chair</b>                  | <b>Executive Conference Room<br/>11; A, B, C, D, E</b> |
| In this breakout session, we will discuss the MAGC Day at the Capitol on January 7, 2013. Also, we will cover practical considerations for planning a trip to the Capitol, suggestions for involving parents and community members, and curriculum connections (including research projects, games and puzzles).                                                                                                                                                                                |                                                                |                                                        |

#### **Breakout Sessions #4: 2:05-2:55**

|                                                                                                                                                                                                                                                                                                                                                                                                                                                                                                                                                                                                                                                                                                                                                                                  |                                                                   |                                              |
|----------------------------------------------------------------------------------------------------------------------------------------------------------------------------------------------------------------------------------------------------------------------------------------------------------------------------------------------------------------------------------------------------------------------------------------------------------------------------------------------------------------------------------------------------------------------------------------------------------------------------------------------------------------------------------------------------------------------------------------------------------------------------------|-------------------------------------------------------------------|----------------------------------------------|
| <b>"Teaching Tools for the 21<sup>st</sup> Century"</b>                                                                                                                                                                                                                                                                                                                                                                                                                                                                                                                                                                                                                                                                                                                          | <b>Carolyn Coil, Ed.D<br/>Pieces of Learning</b>                  | <b>Exhibit Hall A</b>                        |
| Carolyn emphasizes the need for flexibility, independence, choices and resources within the 21 <sup>st</sup> century classroom. Participants will examine research-based 21 <sup>st</sup> century skills needed by gifted students. This session also shows to use important learning theories within a 21st century framework. These include:<br><i>Learning Styles      Learning Modalities      Multiple Intelligences      Bloom's Taxonomy</i>                                                                                                                                                                                                                                                                                                                              |                                                                   |                                              |
| <b>"4-H Robotics: Beyond Plow, Cows, and Sows"</b>                                                                                                                                                                                                                                                                                                                                                                                                                                                                                                                                                                                                                                                                                                                               | <b>Mariah L. Smith, PhD<br/>MSU Extension Service</b>             | <b>Lakeview 1<br/>3, 5, 7; 1, 2, 3</b>       |
| When most of us think of 4-H we think livestock and blue ribbons at the fair. 4-H is that and a great deal more! The 4-H robotics program is an innovative program that introduces youth to robotics and engineering principles. Participants will learn how they can partner with their local county 4-H to introduce exciting activities into the classroom, gain access to resources, and receive free training in robotics programming languages (NXT-G and RobotC).                                                                                                                                                                                                                                                                                                         |                                                                   |                                              |
| <b>"Building a Team from Your Smart Individual:"</b>                                                                                                                                                                                                                                                                                                                                                                                                                                                                                                                                                                                                                                                                                                                             | <b>Maggie Johnston McDowell<br/>Environmental Center Director</b> | <b>Lakeview 2<br/>1, 3, 6, 7; A, B, C, D</b> |
| Do you have students who are great thinkers, but struggle when required to work with peers? You see the leadership potential in your students each day. Help them to see it in themselves. This workshop will guide you through some games and activities you can do to build students' creativity, ability to communicate well and motivation to collaborate with others. Be prepared to get out of your seats and play games!                                                                                                                                                                                                                                                                                                                                                  |                                                                   |                                              |
| <b>"Project Innovate: The Power of Innovation"</b>                                                                                                                                                                                                                                                                                                                                                                                                                                                                                                                                                                                                                                                                                                                               | <b>Deborah Holt<br/>MAGC President-Elect</b>                      | <b>Garden Room</b>                           |
| Project-Innovate was an award-winning project initiated and conducted throughout the Long Beach School District Gifted Program during the 2012-2013 school year. Students researched and wrote books about innovation over time. Students also created their own original inventions and these were submitted to the e-Pals Invent It Challenge. Come meet the international winner from this competition, a fourth grade student who has a patent on her invention. Grade 6 gifted students also made a connection through Global Virtual Classroom with partners from Taiwan who also studied innovation and collaboratively created an educational web, winning 2 <sup>nd</sup> place internationally. This project was awarded the highly competitive Toshiba America grant. |                                                                   |                                              |



|                                                                                                                                                                                                                                                                                                                                                                                                                                                                                                                           |                                                   |                                                 |
|---------------------------------------------------------------------------------------------------------------------------------------------------------------------------------------------------------------------------------------------------------------------------------------------------------------------------------------------------------------------------------------------------------------------------------------------------------------------------------------------------------------------------|---------------------------------------------------|-------------------------------------------------|
| <b>"Championship Chess and Cognitive Outcomes"</b>                                                                                                                                                                                                                                                                                                                                                                                                                                                                        | <b>Dennis Jones<br/>Championship Chess</b>        | <b>Lamar 1<br/>3; A</b>                         |
| Chess is a great way to present students with challenging problem-solving activities. Championship Chess Associate Director Dennis A. Jones will demonstrate how chess can provide puzzles and problems that will enhance cognitive outcomes — visualization, thinking ahead, thinking concretely and abstractly, weighing options, focusing and planning. Whether or not you play chess, you can learn successful teaching strategies for the gifted classroom that will motivate and challenge your gifted students.    |                                                   |                                                 |
| <b>"Fly Me to the Moon"</b>                                                                                                                                                                                                                                                                                                                                                                                                                                                                                               | <b>Ginger Langford<br/>Jackson Public Schools</b> | <b>Lamar 2<br/>2, 3, 4, 5, 6; A</b>             |
| Join us as we use our creative problem solving skills to not only fly to the moon, but explore the moon. Students will create flying machines to launch as well as simulate life in space. They will explore differences between earth and space. Learn about resources available to help enhance your school space program! This is a great hands on curriculum for the reluctant learner.                                                                                                                               |                                                   |                                                 |
| <b>"Making Mississippi's Gifted Excel: The Flagship Programs of MGS and MSMS"</b>                                                                                                                                                                                                                                                                                                                                                                                                                                         | <b>Heath Stevens, Ph.D., LSC, NCC,<br/>ACS</b>    | <b>Forrest 1<br/>1, 2, 3, 7, 12; A, B, C, D</b> |
| This program is designed to give educators an overview of the Mississippi Governor's School (MGS) and the Mississippi School for Mathematics and Science (MSMS). Students often have questions (e.g., being admitted) that are not known outside of program personnel. If you've been fielding any questions about these programs, then this presentation is for you! We'll also allow substantial time for answering any lingering questions about what goes on at MGS and MSMS from an alumnus.                         |                                                   |                                                 |
| <b>"Environmental Awareness is a TOP Priority"</b>                                                                                                                                                                                                                                                                                                                                                                                                                                                                        | <b>Gail Spinnato<br/>McComb School District</b>   | <b>Forrest 2<br/>3; A</b>                       |
| This presentation focuses on environmental issues and ways students can present a drama of an "environmental fairy tale" inspired by the German Fairy Tale Road. Interwoven with the drama are explanations of German and USA environmental protection methods/laws and "green technologies." Students can use their creativity and apply their knowledge of German culture and dramatic performance skills. Discover how you can be part of a two-week study tour of Germany through the Transatlantic Outreach Program! |                                                   |                                                 |

|                                                                                                                                                                                                                                                                                                                                                                                                                                                                                                                                                                                                                                            |                                                          |                                          |
|--------------------------------------------------------------------------------------------------------------------------------------------------------------------------------------------------------------------------------------------------------------------------------------------------------------------------------------------------------------------------------------------------------------------------------------------------------------------------------------------------------------------------------------------------------------------------------------------------------------------------------------------|----------------------------------------------------------|------------------------------------------|
| <b>Breakout Sessions #5: 3:10-4:00</b>                                                                                                                                                                                                                                                                                                                                                                                                                                                                                                                                                                                                     |                                                          |                                          |
| <b>"Solving the Assessment Puzzle Piece by Piece"</b>                                                                                                                                                                                                                                                                                                                                                                                                                                                                                                                                                                                      | <b>Carolyn Coil, Ed.D<br/>Pieces of Learning</b>         | <b>Exhibit Hall A</b>                    |
| Gifted students require challenging learning activities that go beyond rote learning or multiple choice tests. While most teachers of the gifted are aware of this, many find it difficult to assess student products and performances accurately and fairly. In this session we will look at how to develop and use performance and authentic assessments, especially when differentiating classroom instruction. Included is how to link standards to assessments, how to develop assessment criteria for specific products and performances, how and when to create complex rubrics, and how to develop and use product criteria cards. |                                                          |                                          |
| <b>"Flipping the Classroom"</b>                                                                                                                                                                                                                                                                                                                                                                                                                                                                                                                                                                                                            | <b>Will Deyamport, III, Ed.D</b>                         | <b>Lakeview 1<br/>2; A, B, D</b>         |
| This workshop will focus on how teachers can create a classroom environment in which students take responsibility for their own learning. The facilitator will focus on how teachers can use a myriad of web tools and social technologies to develop collaborative learning experiences, produce video and audio tutorials, engage their students in small group discussions, and create an archived repository of learning materials for students.                                                                                                                                                                                       |                                                          |                                          |
| <b>"Engineering in the Classroom"</b>                                                                                                                                                                                                                                                                                                                                                                                                                                                                                                                                                                                                      | <b>Christina McDaniel<br/>MSU College of Engineering</b> | <b>Lakeview 2<br/>3, 15; A, D</b>        |
| This workshop is not for the faint of heart. Come and try some hands-on engineering builds that reinforce the engineering design process, problem solving and metacognitive processes for students. If you prefer to just sit and listen, this is not a session for you!                                                                                                                                                                                                                                                                                                                                                                   |                                                          |                                          |
| <b>"Gifted Referral to Placement...Let's Figure This Out Together"</b>                                                                                                                                                                                                                                                                                                                                                                                                                                                                                                                                                                     | <b>Donna Welborn<br/>MAGC Assessment Chair</b>           | <b>Garden Room<br/>13; A, B, C, D, E</b> |
| This presentation will review the referral to placement process for the gifted education program as per MS Department of Education Regulations. Bring your questions and together we will find the answers. A certificate of completion will be available to meet MDE monitoring requirements.                                                                                                                                                                                                                                                                                                                                             |                                                          |                                          |

|                                                                                                                                                                                                                                                                                                                                                                                                                                                                                                                                                                                                                                                                                            |                                                                                                   |                                    |
|--------------------------------------------------------------------------------------------------------------------------------------------------------------------------------------------------------------------------------------------------------------------------------------------------------------------------------------------------------------------------------------------------------------------------------------------------------------------------------------------------------------------------------------------------------------------------------------------------------------------------------------------------------------------------------------------|---------------------------------------------------------------------------------------------------|------------------------------------|
| <b>"Brainy Games"</b>                                                                                                                                                                                                                                                                                                                                                                                                                                                                                                                                                                                                                                                                      | <b>Judy Dunelew<br/>Teacher's Pet</b>                                                             | <b>Lamar 1<br/>3; A, C</b>         |
| Are you a quick thinker, have a good eye, or just always seem to get the luck of the draw? These brain-bending games can be played in many different ways and settings on several different challenging levels. Learn how to build vocabulary, deductive reasoning and observational skills with these featured award-winning games such as Qwirkle, Mine Shift, Logic Links, Line Up, Look Look Pentago, and many more will be introduced and taught.                                                                                                                                                                                                                                     |                                                                                                   |                                    |
| <b>"Integrating Geography Activities Into the Gifted Classroom"</b>                                                                                                                                                                                                                                                                                                                                                                                                                                                                                                                                                                                                                        | <b>Kay Williams Ed.S<br/>MS Geographic Alliance</b>                                               | <b>Lamar 2<br/>2, 3; A</b>         |
| This session will include a discussion of the services provided by MS Geographic Alliance as well as a brief overview of basic geography lessons that can be used in the classroom to introduce geography skills. Lessons will be available to be copied on a jump drive or CD. Teachers will be exposed to geography activities on a Giant U. S. floor map that can be booked for use at their school.                                                                                                                                                                                                                                                                                    |                                                                                                   |                                    |
| <b>"Socratic Inquiry: Acquiring 21<sup>st</sup> Century Skills from a 4<sup>th</sup> Century B.C.E. Strategy"</b>                                                                                                                                                                                                                                                                                                                                                                                                                                                                                                                                                                          | <b>Richard Courtright, Ph.D.<br/>Duke University TIP<br/>Gifted Education Research Specialist</b> | <b>Forrest 1<br/>2; A, B, D</b>    |
| Among the greatest of teaching-learning models is the Socratic method of inquiry. This centuries-old strategy can be used effectively in today's classroom, in every subject, every grade. The basics of the Socratic seminar that will be presented in this session can be learned in an hour and used throughout a lifetime of teaching. This session will provide the basic "how-to," with step-by-step guidance in how to set up and conduct a seminar, including a rationale, teacher and student expectations/behaviors, the physical environment and content from specific academic disciplines that may be used in the process of implementing Socratic seminars in the classroom. |                                                                                                   |                                    |
| <b>"Creativity, Collaboration, and Communication Through BIZWORLD"</b>                                                                                                                                                                                                                                                                                                                                                                                                                                                                                                                                                                                                                     | <b>Mary Roberts<br/>Petal Elementary</b>                                                          | <b>Forrest 2<br/>3, 5, 7; A, B</b> |
| BizWorld is the perfect program to engage students in creativity, collaboration, and communication. In BizWorld students become entrepreneurs in their own friendship bracelet companies. They create friendship bracelets, persuasive pitches, and marketing campaigns. They collaborate and communicate as they simulate positions in the companies. In this session you will learn how the presenters used Bizworld to engage their students in a real world learning experience.                                                                                                                                                                                                       |                                                                                                   |                                    |

|                                                                                                                                                                                                                                                                                                                                                                                                                                                                                                                                                                                                      |                                                                                            |                                                   |
|------------------------------------------------------------------------------------------------------------------------------------------------------------------------------------------------------------------------------------------------------------------------------------------------------------------------------------------------------------------------------------------------------------------------------------------------------------------------------------------------------------------------------------------------------------------------------------------------------|--------------------------------------------------------------------------------------------|---------------------------------------------------|
| <b>Breakout Sessions #6 4:05p.m.-4:55 p.m.</b>                                                                                                                                                                                                                                                                                                                                                                                                                                                                                                                                                       |                                                                                            |                                                   |
| <b>"Rigor and Relevancy"</b>                                                                                                                                                                                                                                                                                                                                                                                                                                                                                                                                                                         | <b>Dr. Joy Lawson Davis<br/>Author, Consultant, and Member<br/>NAGC Board of Directors</b> | <b>Exhibit Hall A<br/>6, 8, 11; A, B, C, D, E</b> |
| This session will merge evidence based best practices from the fields of Culturally Relevant Teaching with Gifted Education to share strategies most appropriate in creating Rigorous Culturally Relevant Curriculum experiences in core content areas to enhance cross cultural understandings, critical thinking skills all within the foundation of rigorous, trusting, collaborative classroom environments. Effective strategies, models and resources from successful programs serving high ability & gifted learners from culturally diverse populations across the nation will be discussed. |                                                                                            |                                                   |
| <b>"Gifted to the Core"</b>                                                                                                                                                                                                                                                                                                                                                                                                                                                                                                                                                                          | <b>Jen Cornett<br/>Rankin County Schools</b>                                               | <b>Lakeview 1<br/>4, 5; A, B, D</b>               |
| As Common Core sweeps into classrooms, gifted teachers must also reflect and change. This presentation gives background on common core, and then leads teachers through updating their favorite units to include best practices for gifted education and increased rigor of the 21 <sup>st</sup> century classroom. Teachers will leave the presentation with ideas they can implement immediately so that their programs and practices are strengthened and they can assure real impact on student learning.                                                                                        |                                                                                            |                                                   |
| <b>"Mission Intermodal: Bringing Intermodal Global Transportation to Your Classroom"</b>                                                                                                                                                                                                                                                                                                                                                                                                                                                                                                             | <b>Christina McDaniel<br/>MSU College of Engineering</b>                                   | <b>Lakeview 2<br/>3, 5, 15; A</b>                 |
| Planes. Trains. Cargo Ships. Trucks, and Hand carts. How do goods and materials get from the factory to your door? Come and explore some of this dynamic new curriculum for this Professional Development from the College of Engineering at Mississippi State University. This program informs learners in grades 4-8 about the global perspective of transportation and shipping. Learning activities will intrigue your students and get them to ask the big questions.                                                                                                                           |                                                                                            |                                                   |



|                                                                                                                                                                                                                                                                                                                                                                                                                                                                                                                      |                                                |                                                              |
|----------------------------------------------------------------------------------------------------------------------------------------------------------------------------------------------------------------------------------------------------------------------------------------------------------------------------------------------------------------------------------------------------------------------------------------------------------------------------------------------------------------------|------------------------------------------------|--------------------------------------------------------------|
| <b>"Training for New Gifted Contact Persons"</b>                                                                                                                                                                                                                                                                                                                                                                                                                                                                     | <b>Carol Paola<br/>MAGC Executive Director</b> | <b>Garden Room<br/>2, 4, 5, 6, 7, 10, 13, 14; A, B, D, E</b> |
| Are you a new contact person? Are you overwhelmed?!! Do you have lots of questions? This session will include a basic overview of expectations for the gifted contact, testing, regulations, standards, application of Common Core State Standards in curriculum development and more. Sample forms and documents as well as an extended time for questions and answers will be provided.                                                                                                                            |                                                |                                                              |
| <b>"Creative Projects for the Gifted Learner"</b>                                                                                                                                                                                                                                                                                                                                                                                                                                                                    | <b>Kacee Hobson<br/>Rankin County Schools</b>  | <b>Lamar 1<br/>1, 2, 3, 4, 5; A, C, D</b>                    |
| From Crazy Creatures to Wacky Inventions, this session will cover ways to incorporate creative thinking, and other curriculum benchmarks, in the gifted classroom. Practical suggestions for the classroom and ideas for providing a diverse learning environment will be discussed. Teachers will leave full of ideas to create an inspiring space for diverse learners. Plans, rubrics, and handouts will be included and are linked with Common Core curriculum.                                                  |                                                |                                                              |
| <b>"Targeting Conflict Management; Time, Relationships, and Tasks."</b>                                                                                                                                                                                                                                                                                                                                                                                                                                              | <b>Dr. Royal Toy<br/>MUW</b>                   | <b>Lamar 2<br/>1, 7; A, B, C</b>                             |
| Is it always "my way or the highway," or can we plan to change and preserve the relationship, or ignore the conflict completely? This session focuses on providing teachers a common language to use with their students to introduce conflict management styles. Participants will be provided with information and activities that are applicable to addressing socio-emotional needs as well as developing leadership in elementary through high school gifted students.                                          |                                                |                                                              |
| <b>"Everything Old is New Again"</b>                                                                                                                                                                                                                                                                                                                                                                                                                                                                                 | <b>Mary Cole<br/>Engine-Uity, Ltd.</b>         | <b>Forrest 1<br/>5; A, B</b>                                 |
| Now that the last "great idea" has vanished and the new one (aka Common Core) is upon us, what do we do about gifted kids? Just what we've been doing for years: differentiate. The CCS emphasis on rigorous content, application of knowledge through higher-order thinking skills, and research as an important skill throughout subject areas/strands is indeed a gift to GATE. Come learn how one tried-and-true strategy (Bloom's Taxonomy) will help you meet gifted students' needs within the CCS framework. |                                                |                                                              |
| <b>"Inspiring Future Engineers Through Robotics"</b>                                                                                                                                                                                                                                                                                                                                                                                                                                                                 | <b>Donna Mabus<br/>Brandon Elementary</b>      | <b>Forrest 2<br/>3; A</b>                                    |
| Involvement in the FIRST LEGO League (FLL) competition helps your gifted students hone their 21st Century skillset while they CREATE innovative solutions to a challenging real-world problem, COLLABORATE with mentors outside the classroom, use engineering strategies to program an autonomous robot to accomplish a set of missions, work together as a team of professionals, and COMMUNICATE their solutions in a variety of ways to an authentic audience. Come learn how to successfully coach a team.      |                                                |                                                              |

|                                                                                                                                                                                                                                                                                                                                                                                                                                                                                                                                                                                                                                                                               |                                                                                    |                                                  |
|-------------------------------------------------------------------------------------------------------------------------------------------------------------------------------------------------------------------------------------------------------------------------------------------------------------------------------------------------------------------------------------------------------------------------------------------------------------------------------------------------------------------------------------------------------------------------------------------------------------------------------------------------------------------------------|------------------------------------------------------------------------------------|--------------------------------------------------|
| <b>Friday Breakout Sessions #7 10:10-11:00</b>                                                                                                                                                                                                                                                                                                                                                                                                                                                                                                                                                                                                                                |                                                                                    |                                                  |
| <b>"Differentiated Activities and Assessments Using the Common Core Standards"</b>                                                                                                                                                                                                                                                                                                                                                                                                                                                                                                                                                                                            | <b>Carolyn Coil, Ed.D<br/>Pieces of Learning</b>                                   | <b>Exhibit Hall A</b>                            |
| This session serves as a follow-up to Carolyn's keynote. You will see specific examples showing how the Common Core Standards can benefit gifted and high ability learners. Examine a variety of practical differentiated activities and units with corresponding assessments that use the Common Core Standards, extend learning, and are appropriate for gifted kids.                                                                                                                                                                                                                                                                                                       |                                                                                    |                                                  |
| <b>"A Freudian Analysis of Literature"</b>                                                                                                                                                                                                                                                                                                                                                                                                                                                                                                                                                                                                                                    | <b>Dr. Ken Smith<br/>Author and District Enrichment Coordinator Northfield, IL</b> | <b>Lakeview 1<br/>2, 3, 4, 5, 8, 13; A, B, D</b> |
| Language Arts Common Core Standards present high-level challenges, yet gifted learners may still go beyond what these standards require. Rather than go to the next grade-level's standards, Ken Smith suggests adding more complexity to literary units by using Freudian Psychology to analyze texts. In this workshop, Ken presents how to teach Freud's key concepts and then to have students use these concepts to analyze literature. He also explains how students can use Freud's principles to impact their own writing. The sample texts for this workshop are Lord of the Flies and The Cat in the Hat. This workshop won the NAGC 2012 Curriculum Studies Award. |                                                                                    |                                                  |

|                                                                                                                                                                                                                                                                                                                                                                                                                                                                                                                                                                                                                                                                                                                                                                                              |                                                                                                                                      |                                            |
|----------------------------------------------------------------------------------------------------------------------------------------------------------------------------------------------------------------------------------------------------------------------------------------------------------------------------------------------------------------------------------------------------------------------------------------------------------------------------------------------------------------------------------------------------------------------------------------------------------------------------------------------------------------------------------------------------------------------------------------------------------------------------------------------|--------------------------------------------------------------------------------------------------------------------------------------|--------------------------------------------|
| <b>"No Room for a Sneeze and More From EconEdLink"</b>                                                                                                                                                                                                                                                                                                                                                                                                                                                                                                                                                                                                                                                                                                                                       | <b>James Wilcox, MCEE<br/>Director, University of Southern<br/>Mississippi Center for Economic<br/>and Entrepreneurial Education</b> | <b>Lakeview 2<br/>2, 3, 5, 7; A, B, D</b>  |
| EconEdLink provides a premier source of classroom-tested, Internet-based economic and personal finance lesson materials for K-12 teachers and their students. With over 785 lessons to choose from, teachers can use as many of the lessons as they would like and as often as they would like. The Internet-based lessons are targeted for K-12 teachers and their students. Each of the lessons includes a teacher's version as well as a student's version. Each of the lessons are designed to be delivered in a variety of formats and class-room settings.                                                                                                                                                                                                                             |                                                                                                                                      |                                            |
| <b>Creativity101</b>                                                                                                                                                                                                                                                                                                                                                                                                                                                                                                                                                                                                                                                                                                                                                                         | <b>Brooke Bowden<br/>Petal Schools</b>                                                                                               | <b>Garden Room<br/>1, 2, 3, 5; A, C, D</b> |
| Creativity is a 21 <sup>st</sup> century skill we can teach and assess. It helps build confidence and fosters deeper learning. Developing a child's creativity will help them become comfortable with being themselves in the classroom. This is the session for you if you would like to know how to implement, assess, and teach creativity in your classroom! We will share a variety of ideas to help teach creative thinking skills in your classroom!                                                                                                                                                                                                                                                                                                                                  |                                                                                                                                      |                                            |
| <b>"On A Roller Coaster: Newton's<br/>Laws of Fun</b>                                                                                                                                                                                                                                                                                                                                                                                                                                                                                                                                                                                                                                                                                                                                        | <b>Jen Cornett<br/>Rankin County Schools</b>                                                                                         | <b>Lamar 1<br/>3; A, B</b>                 |
| How can you combine research, social skills, the scientific method, math concepts, creativity, and teamwork? Roller Coasters! This session features a 6-week Motion unit with weekly activities and experiments leading up to the final assessment – student created, working roller coasters! Teachers will leave this session with a unit that aligns Common Core standards with Gifted Best practices that can be used immediately or adapted for varying age levels or student needs.                                                                                                                                                                                                                                                                                                    |                                                                                                                                      |                                            |
| <b>"Journaling Success in The Gifted<br/>Classroom"</b>                                                                                                                                                                                                                                                                                                                                                                                                                                                                                                                                                                                                                                                                                                                                      | <b>Michelle Turner<br/>Vicksburg-Warren School District</b>                                                                          | <b>Lamar 2<br/>2, 3, 5; A</b>              |
| Creating students that think creatively and metacognitively is the desire of every teacher. So how do we accomplish this? For starters, we get them going by charging them with thought evoking writing prompts and crank their creative gears through visual journal prompts. In this session, I give examples of journaling methods, materials, and prompts that help get students thinking critically, as well as the importance of developing strong metaphorical writing skills as we embark upon Common Core Standards and Assessments.                                                                                                                                                                                                                                                |                                                                                                                                      |                                            |
| <b>"Pulling it All Together: A<br/>Synthesis Model for Differentiated<br/>Curriculum for the Gifted Learner"</b>                                                                                                                                                                                                                                                                                                                                                                                                                                                                                                                                                                                                                                                                             | <b>Richard Courtright, Ph.D.<br/>Duke University TIP<br/>Gifted Education Research<br/>Specialist</b>                                | <b>Forrest 1<br/>2; A, B</b>               |
| This session will present a model that illustrates the interrelationships among a variety of systems and models in gifted and general education. Understanding the model can enable teachers and other educators to function as active designers of appropriately differentiated curriculum for gifted learners. Drawing together the work of such notable leaders as Gallagher, Bloom, Hirsch, Adler, Renzulli, Kaplan, Sternberg, and others, the end result offers a graphic representation of the correlation of the individual's endogenous characteristics, the design of the curriculum and the implementation of instruction. Highlighting the interrelated factors of these concepts fosters the disposition that differentiation <i>can</i> be – as well as <i>must</i> be – done. |                                                                                                                                      |                                            |
| <b>"Medieval Marshmallows"</b>                                                                                                                                                                                                                                                                                                                                                                                                                                                                                                                                                                                                                                                                                                                                                               | <b>Sherra McElroy<br/>Ingomar Attendance Center</b>                                                                                  | <b>Forrest 2<br/>2; A</b>                  |
| Who says physics can't be fun? Science isn't "uggghhh!" anymore when it involves building a mini catapult to teach students about projectile motion and potential energy. Incorporate art and reading by creating a family coat of arms, studying medieval times, and creating circulars for your own classroom medieval catapult tournament. By using marshmallow ammunition and a little ingenuity, students can launch their learning and triumph in science.                                                                                                                                                                                                                                                                                                                             |                                                                                                                                      |                                            |

#### **Breakout Sessions #8: 11:10-12:00**

|                                                                                                                                                                                                                                                                                                                                                                                                                                                                                                                                                     |                                                                                      |                                            |
|-----------------------------------------------------------------------------------------------------------------------------------------------------------------------------------------------------------------------------------------------------------------------------------------------------------------------------------------------------------------------------------------------------------------------------------------------------------------------------------------------------------------------------------------------------|--------------------------------------------------------------------------------------|--------------------------------------------|
| <b>"A Common Core Up-Date for<br/>Gifted Educators"</b>                                                                                                                                                                                                                                                                                                                                                                                                                                                                                             | <b>Chauncey Spears<br/>MDE Director of Advanced<br/>Learning and Gifted Programs</b> | <b>Exhibit Hall A<br/>5; A, B, C, D, E</b> |
| As expectations increase in the regular classroom for implementation of the Common Core State Standards, gifted education must reach new heights to challenge gifted students. Teachers of the gifted can serve as partners in the process of making students "college, career, and citizen ready." This session will provide an update of ways in which gifted educators can help students build Common Core and 21 <sup>st</sup> Century Skills while staying in compliance with MDE required gifted outcomes, gifted standards, and regulations. |                                                                                      |                                            |



|                                                                                                                                                                                                                                                                                                                                                                                                                                                                                                                                                                                                                                                                                                                                                                                                          |                                                                                              |                                              |
|----------------------------------------------------------------------------------------------------------------------------------------------------------------------------------------------------------------------------------------------------------------------------------------------------------------------------------------------------------------------------------------------------------------------------------------------------------------------------------------------------------------------------------------------------------------------------------------------------------------------------------------------------------------------------------------------------------------------------------------------------------------------------------------------------------|----------------------------------------------------------------------------------------------|----------------------------------------------|
| <b>"Storytelling: Just for the Fun (and the Cognitive Challenge) of It"</b>                                                                                                                                                                                                                                                                                                                                                                                                                                                                                                                                                                                                                                                                                                                              | <b>Dr. Ken Smith</b><br>Author and District Enrichment Coordinator Northfield, IL            | <b>Lakeview 1</b><br>2, 3, 4, 5, 7; A, D     |
| Research suggests that talented writers engage in a writing model that is qualitatively superior to that used by more typical students. These writers tend to form a network of interrelated subproblems that are solved as the writer moves from initial idea to final text. This model has implications for the role storytelling can play in the classroom. In this entertaining workshop, Ken Smith teaches you how to use this expert writing model to teach your students the art of storytelling. Moreover, the skills students develop for storytelling can help them improve their writing.                                                                                                                                                                                                     |                                                                                              |                                              |
| <b>"Ensuring Equity and Excellence in Gifted Education Programs"</b>                                                                                                                                                                                                                                                                                                                                                                                                                                                                                                                                                                                                                                                                                                                                     | <b>Dr. Joy Davis</b><br>Author, Consultant, and Member NAGC Board of Directors               | <b>Lakeview 2</b><br>1, 6, 8; A, B, C, D, E  |
| As our schools increase in diversity, students participating in gifted and advanced learner programs will become more representative of the general population. As such, program services will change to meet the unique need of culturally and linguistically diverse learners and their families. Gifted education services should not be 'watered down' but maintain its standard of high end teaching and learning for ALL students. This session will provide keys to ensuring equity and excellence in gifted education programs as student, family and community demographics change. The intellectual, academic, affective and other support needs of culturally diverse students will be shared by examples. Student case studies will be used to discuss implementation of selected practices. |                                                                                              |                                              |
| <b>"Civic Engagement for Gifted Kids: Welcome to Jolly Town"</b>                                                                                                                                                                                                                                                                                                                                                                                                                                                                                                                                                                                                                                                                                                                                         | <b>Carol Paola</b><br>MAGC Executive Director                                                | <b>Garden Room</b><br>2, 3, 4, 5, 7, 8; A, D |
| "Welcome to Jolly Town!" This session will include activities designed to build relationships with elected officials while engaging kids in hands-on, high level thinking and product development. Participate in a simulation demo, then follow students as they studied authority, planned a new town, obtained a charter, ran campaigns, held elections, conducted council meetings, and more. The activities, contracts, rubrics for evaluation, and an introduction to a GREAT website with electronic learning modules will be shared.                                                                                                                                                                                                                                                             |                                                                                              |                                              |
| <b>"Get Creative! Sneak Social Studies into Your Lessons"</b>                                                                                                                                                                                                                                                                                                                                                                                                                                                                                                                                                                                                                                                                                                                                            | <b>Stacey Everett</b><br>MS Dept. of Archives and History                                    | <b>Lamar 1</b><br>5; A, B                    |
| Come and explore online lessons and teaching units offered by the Mississippi Department of Archives and History. The MDAH has recently begun to develop a teacher reviewed, Common Core aligned, collection of online teaching resources based in social studies but addressing math, science, arts, literature and grammar. Presenters will introduce the new resources and ways in which units, lessons, or activities can be integrated into your gifted classroom.                                                                                                                                                                                                                                                                                                                                  |                                                                                              |                                              |
| <b>"To Read or Not to Read"</b>                                                                                                                                                                                                                                                                                                                                                                                                                                                                                                                                                                                                                                                                                                                                                                          | <b>Sherry Willis</b><br>Tupelo Schools                                                       | <b>Lamar 2</b><br>1, 3, 5, 7; A              |
| Have you been looking for a literature unit that interests gifted learners but doesn't take too much time out of your day? This session will feature a literature unit that uses books from one author to teach a plethora of skills such as science, art, writing, deductive reasoning, and high order thinking. Come join me for a look at some great books! Handouts and lesson plans will be available.                                                                                                                                                                                                                                                                                                                                                                                              |                                                                                              |                                              |
| <b>TIP-ical Kids: Social and Emotional Aspects of High Ability Children and Youth</b>                                                                                                                                                                                                                                                                                                                                                                                                                                                                                                                                                                                                                                                                                                                    | <b>Richard Courtright, Ph.D.</b><br>Duke University TIP Gifted Education Research Specialist | <b>Forrest 1</b><br>1; A, B, C, D, E         |
| Thirty years of working with gifted students in Duke TIP summer programs has provided evidence of the nature of the characteristics of gifted/talented students. While individual differences (and exceptions to the rule) abound, there are strong tendencies among gifted kids regarding their social and emotional development that can inform parents and teachers, helping them to understand the response they receive from their children and students. Awareness of these characteristics can turn the "rough seas" of interactions in school and in the home into "smooth sailing" for everyone involved.                                                                                                                                                                                       |                                                                                              |                                              |
| <b>"Order in the Court"</b>                                                                                                                                                                                                                                                                                                                                                                                                                                                                                                                                                                                                                                                                                                                                                                              | <b>Carly Parker</b><br>Long Beach Schools                                                    | <b>Forrest 2</b><br>3, 7; A                  |
| Teachers of the gifted will discover a real world simulation in the area of Law that meets multiple state process skills. It will show how to help students establish a basic understanding of courtroom procedures and give them the opportunity to participate in a Mock Trial. Also, it will allow students to not only learn the concepts of law, but also the value of teamwork, time management skills, and various other skills required in preparation for a Mock Trial. The presentation will show how field studies can be connected to aid in the understanding of the study of law.                                                                                                                                                                                                          |                                                                                              |                                              |





Stop by the  
**Mississippi Geographic Alliance**  
table for a free membership and new  
member map!



**NATIONAL  
GEOGRAPHIC**

Education Foundation



**MISSISSIPPI  
GEOGRAPHIC  
ALLIANCE**

*Connect to the world here.*

# Teacher's Pet

**Kids Are Our Business!**

**Learning Products for  
School, Church & Home  
Tutoring Services**

**Store Hours:  
Mon-Sat 10am-5:30pm**

Email:  
teacherspet9763@comcast.net

**Jerry & Judy Dunelew, Owners**

**662.840.9763**

**1252 W. Main St. • Tupelo, MS 38801**

**www.teacherspetinc.com**



**THE UNIVERSITY OF  
SOUTHERN MISSISSIPPI**

**The Frances A. Karnes Center for Gifted Studies**  
College of Education and Psychology

## **2014 SUMMER RESIDENTIAL PROGRAMS**

Leadership Studies Program • June 15-20 • Grades 6-11

Summer Gifted Studies Program • June 22-27 • Grades 4-8

Summer Program for Academically Talented Youth  
July 6-25 • Grades 7-10

## **PROGRAMS FOR TEACHERS**

Certification in gifted education: master's, specialist  
and doctorate with an emphasis in gifted education



118 College Drive #8207  
Hattiesburg, MS 39406-0001  
601.266.5236

Email: [gifted.studies@usm.edu](mailto:gifted.studies@usm.edu)  
[www.usm.edu/gifted](http://www.usm.edu/gifted)

# Inspiring **MATH** Excellence Through Competition

## Math Competition For Grades 3-8

### Gold Medal For Your Top Team Member

- Plaques For Teams In Top 10% In Each Grade
- Dogtags For Students In Top 10% In Each Grade

Tests Can Be Taken Online or Printed Out  
And Taken In The Classroom.

**SIGN UP TODAY AT:**

**[www.PerennialMath.com](http://www.PerennialMath.com)**  
**or call 888-835-2366**



NOTES

## MAGC is on Facebook!

Get the latest updates on:

- ✓ Our Annual Conference
- ✓ PD Opportunities
- ✓ Networking

Join us today by  
searching MAGC.

# WHY MPE?

The premier package of benefits for the least amount of money!



| 2013 - 2014 DUES                          | MPE   | OTHER ORGANIZATION(S) |
|-------------------------------------------|-------|-----------------------|
| Professional with liability insurance     | \$120 | \$447* - \$498*       |
| Couples with liability insurance          | \$200 | -NA-                  |
| First Year Professional                   | \$90  | -NA-                  |
| Non-certified or part-time with insurance | \$60  | \$159* - \$243*       |
| Student Teacher with insurance            | \$14  | \$21* - \$25*         |
| Retired Educator without insurance        | \$10  | \$65*                 |

\* May not include local dues

Professional liability protection of \$2 million with \$3 million maximum  
(other organizations provide only \$1 million with \$3 million maximum)

Legal assistance related to employment or professional matters per MPE policy

\$10,000 in accidental death & dismemberment coverage

\$2,500 assault related property damage (5x the coverage of another organization)

Only organization to include identity theft coverage with membership

Graduate & Undergraduate Scholarships awarded annually

Classroom Grant opportunities

Free Regional Trainings

Unlimited professional advice available 24 hours per day/7 days  
per week (included with membership)

Every dollar of your dues stays in Mississippi for your benefit!  
MPE does not utilize dues to support political candidates.

And the benefits continue.....

Staff lobbyists monitor legislation at state capitol, with weekly updates  
provided to membership

Weekly emails notify members of important MPE news/events, as well as state and national  
educational updates

MPE Journal published three times per year (included with membership)

BrightView Credit Union membership

Member discount program

Optional long term care coverage at a discounted rate

Group discount on auto/home insurance with Liberty Mutual

Optional vision and dental benefits



[www.mpe.org](http://www.mpe.org) or call (800)523-0269

MISSISSIPPI PROFESSIONAL EDUCATORS



**Earn CEU's, OSL's, and SEMI's completely online.**

Each six-week course earns 2.0 CEUs, 1 OSL, or 15 SEMIs.  
Registration per course is \$49.00, and the fee includes CEU, OSL, or SEMI certificate.

Enhance your resume.  
Earn a professional certificate through the Professional Learning Academy.

Six certificates are offered in Collaboration, Common Core Instruction,  
Emotional Intelligence, Leadership, 21st Century Teaching,  
and 21st Century Skills for the Workplace.

Basic computer skills and high speed internet are required.

[www.muw.edu/ccl](http://www.muw.edu/ccl)

Projects: Professional Learning

**For more information contact Professional Learning  
at (662) 329-7288 or email [pl@ccl.muw.edu](mailto:pl@ccl.muw.edu).**





Mississippi University for  
Women presents...

**T.G.I.F.**

TEACHERS *of* THE GIFTED  
INSTRUCTIONAL FORUM

**2 0 1 4**

**[FRIDAY]**

**{ Feb. 21 }**

8:30 A.M. – 3:30 P.M.

MUW CAMPUS

**THEME: Getting to the Core of inteGReATion**

**Connecting Common Core, Gifted Standards, & 21<sup>st</sup> Century Learning**

**Who:** K-12 gifted specialists & general ed teachers

**What:** Presentations and resources from guest presenters,  
MUW faculty, and teachers like you

**Why:** Earn CEUs, network with teachers, & gain practical ideas

**[www.muw.edu/tgif](http://www.muw.edu/tgif)**

**\$40 Pre-registration includes breakfast & lunch**

**\$20 student rate**

**Contact:** Dr. April Coleman ([ancoleman@edhs.muw.edu](mailto:ancoleman@edhs.muw.edu))  
or Arden Mason ([amazon@edhs.muw.edu/662-329-7365](mailto:amazon@edhs.muw.edu/662-329-7365))

# What are you waiting for?

*Master of Education in Gifted Studies  
Gifted Certification Online*

# The W

**Enroll Now!**

*Spring pre-registration  
begins October 28th.*



The Master's program in Gifted Studies provides special advanced training and leadership experiences for professionals who are committed to programming for gifted students. Graduate students in Gifted Studies must take a minimum of 36 hours of graduate coursework.



The Gifted Certification program is for licensed teachers who want to earn an additional certificate in Gifted Studies. The program begins in the summer and ends in the spring. Certification requires 15 hours of coursework.

## Application Information:

(662) 329-7365 or

1-877-462-8439 ext 7365

or [amason@edhs.muw.edu](mailto:amason@edhs.muw.edu)

## Financial Aid Information:

Financial aid is available to part-time and full-time students after acceptance into the Master's program.  
(662) 329-7114

Graduate Scholarships are available from the Graduate Studies in Education office for those pursuing certification only.

**Mississippi University for Women**  
*A Tradition of Excellence for Women and Men*

# Louisiana Renaissance Festival



[www.LARF.org](http://www.LARF.org)

Six Weekends

2013

November 2nd - December 8th

2 Weeks Before Thanksgiving - 1 Week Before Christmas

November 2, 3, 9, 10, 16, 17, 23, 24, 29, 30 December 1, 7, 8 | Rain or Shine! | 9:45am - 5:00pm  
Visit our website for more information, including Theme Weekends & Special Events



The Village of Filbriht invites you to experience the depiction of sixteenth century England when Queen Elizabeth I was in charge and music, art and literature took center stage. You will be well met by various villagers and watch knights in armour battle on horseback and birds of prey fly overhead. Enjoy period demonstrations performed by the glass-blower, blacksmith, cooper-smith, candle-maker, baker and weaver just to name a few! Find unique gifts from artisans in the village, many of whom make their product before your eyes. Your day would not be complete without food fit for a king. Whether it's a turkey leg, steak on a stick, or jester chips, there is something for everyone, including you! An assortment of entertainment abounds on a dozen stages throughout Filbriht. Storytelling, puppets, music, juggling, sword fighting and jousting are but a handful of what you will encounter during your visit. Plan to spend the day with us in Filbriht where not only will you be entertained, but you may just learn a thing or two!

## Six Weekends

Beginning November  
46465 River Road  
Hammond, La 70401

[www.larf.org](http://www.larf.org)

Best Festival in History







*MAGC thanks Long Beach  
School District and RPM  
Domino's Pizza, L.L.C.-Mr.  
Glenn Mueller, CEO, for your  
support of MAGC Conference  
2013, and Gifted  
Education*



## **The Long Beach School District Excellence, Courage and Perseverance**

The City of Long Beach, Mississippi was incorporated as a town on August 10, 1905, though it had been a growing settlement since the mid 1800's. It is located on Mississippi's Gulf Coast, just west of Gulfport and bordered to the south by the Gulf of Mexico and a sugar white, man-made sand beach. "The Friendly City" is the name aptly used as the town's slogan, and over 15,000 citizens have made this community a "friendly" place to call home.

Long Beach School District, with Superintendent Carolyn Hamilton at the helm, serves a diverse student population of approximately 2979 students, with 375 students being served in the gifted program, Discovery. The district has a rich history of academic excellence, including an average ACT Composite Score of 22.6, compared to 20.1 statewide (MDE NCLB Report Card 2011). There were two National Merit Finalists in the recent graduating class, with one student being awarded a Harvard Scholarship. LBSD students in grade 8 have consistently scored 1<sup>st</sup> in the state on the state science test. LBSD had a middle school 7<sup>th</sup> grade student rank first place in the MCTM (Mississippi Council for Teachers of Mathematics) Math Tournament this past year. Long Beach had an elementary grade 4 gifted student place first in the international e-Pals Invent It Challenge, and her invention is in the patent process. These are just a few examples of the excellence exemplified in the Long Beach School District.

If you ever yearn to feel the sea breeze on your face and the sand beneath your toes, find your way to Long Beach, Mississippi: A "friendly" place to visit and a beautiful place to call home.

# MISSISSIPPI ASSOCIATION FOR GIFTED CHILDREN

2013 ANNUAL CONFERENCE, September 26-27, 2013

## CEU Credit Documentation Form

Please complete the information below. A facilitator will sign this form at the beginning and end of each session. In order to receive a CEU Certificate from MUW, please mail your form and a \$20.00 check payable to MUW to: Mississippi University for Women, 1100 College Street, MUW-1635, Columbus, MS 39701.

Name \_\_\_\_\_ Social Security # \_\_\_\_\_ Phone \_\_\_\_\_

Address \_\_\_\_\_ City \_\_\_\_\_ State \_\_\_\_\_ ZIP \_\_\_\_\_

E-mail \_\_\_\_\_

| Date                               | Hours                         | Session Title                                                                                                         | Authorized<br>Signature<br>Sign In | Authorized<br>Signature<br>Sign Out |
|------------------------------------|-------------------------------|-----------------------------------------------------------------------------------------------------------------------|------------------------------------|-------------------------------------|
| Thursday,<br>September<br>26, 2013 | 8:30 a.m.<br>-<br>9:45 a.m.   | <b>General Session 1</b><br><i>Planning for Change: 21<sup>st</sup> Century Gifted Teachers</i><br>Mark Runco         |                                    |                                     |
|                                    | 10:00 a.m.<br>-<br>10:50 a.m. | <b>Breakout Session 1</b><br>Title: _____<br>Speaker: _____                                                           |                                    |                                     |
|                                    | 10:55 a.m.<br>-<br>11:45 a.m. | <b>Breakout Session 2</b><br>Title: _____<br>Speaker: _____                                                           |                                    |                                     |
|                                    | 1:10 p.m.<br>-<br>2:00 p.m.   | <b>Breakout Session 3</b><br>Title: _____<br>Speaker: _____                                                           |                                    |                                     |
|                                    | 2:05 p.m.<br>-<br>2:55 p.m.   | <b>Breakout Session 4</b><br>Title: _____<br>Speaker: _____                                                           |                                    |                                     |
|                                    | 3:10 p.m.<br>-<br>4:00 p.m.   | <b>Breakout Session 5</b><br>Title: _____<br>Speaker: _____                                                           |                                    |                                     |
|                                    | 4:05 p.m.<br>-<br>4:55 p.m.   | <b>Breakout Session 6</b><br>Title: _____<br>Speaker: _____                                                           |                                    |                                     |
|                                    | 5:30 p.m.<br>-<br>6:30 p.m.   | <b>Family Night</b><br>Dr. Joy Davis                                                                                  |                                    |                                     |
|                                    |                               |                                                                                                                       |                                    |                                     |
| Friday,<br>September<br>27, 2013   | 8:00 a.m.<br>-<br>10:00 a.m.  | <b>General Session 2</b><br><i>Common Core, 21<sup>st</sup> Century Learning and the Gifted Child</i><br>Carolyn Coil |                                    |                                     |
|                                    | 10:10 a.m.<br>-<br>11:00 a.m. | <b>Breakout Session 7</b><br>Title: _____<br>Speaker: _____                                                           |                                    |                                     |
|                                    | 11:10 a.m.<br>-<br>12:00 p.m. | <b>Breakout Session 8</b><br>Title: _____<br>Speaker: _____                                                           |                                    |                                     |

1.2 CEU Credits have been approved for attending the 2013 MAGC Annual Conference.



## Domino's Pizza: Encourages Innovation and Entrepreneurial Spirit

Next time you order a pizza for delivery, note the insulated bag that keeps your pie piping hot all the way to your door. While you're tipping the driver, take a glance at the car. Chances are you'll spot one of those illuminated portable car-top signs. Now tip your hat to Glenn Mueller and the gang at RPM Pizza, Domino's largest franchisee, because both the bag and the car-top sign are RPM innovations that have become ubiquitous in the food delivery business. Founded in 1981 by Mueller and his brother Richard, RPM is one of those franchisees that could almost annoy corporate with their steady stream of ideas, admits Jim Stansik, executive vice president of franchise relations for Domino's. That is, if it weren't for the fact that they've had so many big hits. The hot bag and car-top sign are two of the biggest, but there are others. RPM was the first in the Domino's system to establish drive-thrus and carryout-only stores in smaller markets. It was the first to develop modular stores with components built off-site.



*Shop  
Petal  
First*

IT'S MORE THAN SHOPPING,  
IT'S AN EXPERIENCE!

VISIT OUR "SHOP PETAL  
FIRST" FACEBOOK PAGE FOR  
UPDATES.

**NOVEMBER 21-23**



NOTES





## 2012 CONFERENCE EVALUATION FORM

Thank you for helping us plan next year's conference by completing this survey at the close of the conference. Please place it in one of the designated boxes.

1. I live in this region of the state:

☐ North ☐ South ☐ Central

2. My major involvement with gifted education is:

☐ educational ☐ parental ☐ other (specify) \_\_\_\_\_

3. I have been involved with gifted education for:

☐ 0-4 years ☐ 5-9 years ☐ 10 or more years

4. Please rate the overall quality of the following conference elements (*circle one for each*):

|                       |               |         |               |
|-----------------------|---------------|---------|---------------|
| Registration Process  | above average | average | below average |
| Conference Facilities | above average | average | below average |
| Keynote Speakers      | above average | average | below average |
| Breakout Sessions     | above average | average | below average |
| Family Night          | above average | average | below average |
| Vendors               | above average | average | below average |

Comments on any of the above: \_\_\_\_\_

5. Are you glad you attended this conference?

Yes

No

6. Do you plan on attending future MAGC conferences?

Yes

No

7. Which breakout session presenters would you recommend for future conferences?

\_\_\_\_\_  
\_\_\_\_\_

8. What topics would you like to see emphasized at future conferences?

\_\_\_\_\_  
\_\_\_\_\_  
\_\_\_\_\_

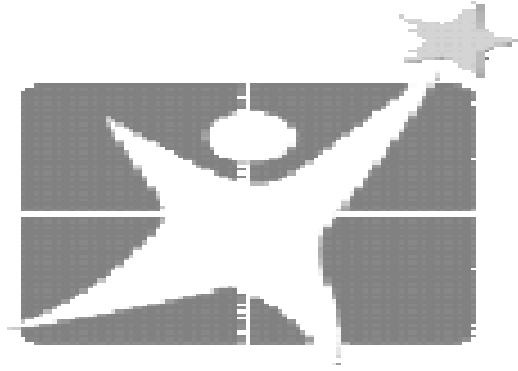

**LAMAR COUNTY EXCEL  
WELCOMES YOU TO HATTIESBURG!**

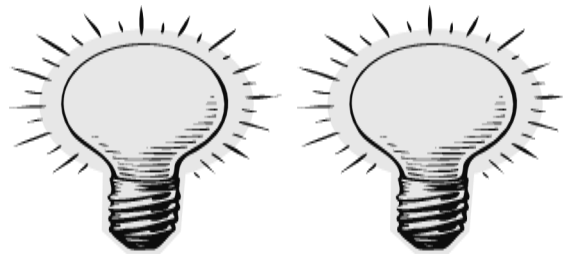

**BRIGHT MINDS EXCEL!**



**NOTES**



*Petal 2014 Distinguished Young Woman  
State DYW Preliminary Talent Winner*



MAGC welcomes Breanna Traweek to the 2013 Conference. Breanna is the daughter of Denice Traweek and the late Art Traweek. She attends Petal High School where she is treasurer of the Student Council, a member of the Soundsations Showchoir, and serves on the District Shared Decision Making Council. Other activities include UCA All American Cheerleader, guitar, vocals, 2013 Most Beautiful Junior Class, Top Three Best Soloists at MSC, Mu Alpha Theta, and Mission Work.



# PLANNING FOR CHANGE



**ARTWORK BY LONG BEACH SCHOOL  
DISTRICT GIFTED PROGRAM**